

Bauer Style - Type B

TYPE B

Female Socket x Shank



Part Number	Size
BLSS-300	3"
BLSS-400	4"
BLSS-600	6"
BLSS-800	8"
BLSS-1000	10"
BLSS-1200	12"

Male Ball x Shank



Part Number	Size
BLBS-300	3"
BLBS-400	4"
BLBS-600	6"
BLBS-800	8"
BLBS-1000	10"
BLBS-1200	12"

Female Socket x Machine Shank (KC)



Part Number	Size
BLSK-300	3"
BLSK-400	4"
BLSK-600	6"
BLSK-800	8"

Male Ball x Machine Shank (KC)



Part Number	Size
BLBK-300	3"
BLBK-400	4"
BLBK-600	6"
BLBK-800	8"

Female Socket x ANSI Flange



Part Number	Size
BLSFL-400	4"
BLSFL-600	6"
BLSFL-800	8"
BLSFL-1000	10"
BLSFL-1200	12"

Male Ball x ANSI Flange



Part Number	Size
BLBFL-400	4"
BLBFL-600	6"
BLBFL-800	8"
BLBFL-1000	10"
BLBFL-1200	12"

Female Socket x ANSI Flange Increases



Part Number	Size
BLIFLS-400600	4" Flange x 6" Socket
BLIFLS-600800	6" Flange x 8" Socket

Male Ball x ANSI Flange Increases



Part Number	Size
BLIFLB-400600	4" Flange x 6" Socket
BLIFLB-600800	6" Flange x 8" Socket

Female Socket x ANSI Flange Reducers



Part Number	Size
BLRFLS-1000800	10" Flange x 8" Socket
BLRFLS-1200800	12" Flange x 8" Socket

Male Ball x ANSI Flange Reducers



Part Number	Size
BLRFLB-1000800	10" Flange x 8" Ball
BLRFLB-1200800	12" Flange x 8" Ball

BECAUSE WE CONTINUALLY EXAMINE WAYS TO IMPROVE OUR PRODUCTS, WE RESERVE THE RIGHT TO ALTER SPECIFICATIONS WITHOUT NOTICE.

Bauer Style - Type B

TYPE B



Female Socket x Male NPT

Part Number	Size
BLSM-300	3"
BLSM-400	4"
BLSM-600	6"
BLSM-800	8"



Male Ball x Male NPT

Part Number	Size
BLBM-300	3"
BLBM-400	4"
BLBM-600	6"
BLBM-800	8"



Inline T with Male Branch

Part Number	Size
BLTMB-400	4"
BLTMB-600	6"
BLTMB-800	8"



Inline T with Female Branch

Part Number	Size
BLTFB-400	4"
BLTFB-600	6"
BLTFB-800	8"



Male Ball x Female Socket 45°

Part Number	Size
BLEL45-400	4"
BLEL45-600	6"
BLEL45-800	8"
BLEL45-1000	10"
BLEL45-1200	12"



Male Ball x Female Socket 90°

Part Number	Size
BLEL90-400	4"
BLEL90-600	6"
BLEL90-800	8"
BLEL90-1000	10"
BLEL90-1200	12"



Double Male Ball

Part Number	Size
BLYDBS-400	4"
BLYDBS-600	6"
BLYDBS-800	8"
BLYDBS-1200	12"



Double Female Socket

Part Number	Size
BLYDSB-400	4"
BLYDSB-600	6"
BLYDSB-800	8"
BLYDSB-1200	12"



Female Socket x Male Ball Reducer

Part Number	Size
BLRSB-600400	6" x 4"
BLRSB-800600	8" x 6"
BLRSB-1000800	10" x 8"
BLRSB-1200800	12" x 8"



Female Socket x Male Ball Increaser

Part Number	Size
BLISB-400600	4" x 6"
BLISB-600800	6" x 8"
BLISB-8001000	8" x 10"
BLISB-8001200	8" x 12"

BECAUSE WE CONTINUALLY EXAMINE WAYS TO IMPROVE OUR PRODUCTS, WE RESERVE THE RIGHT TO ALTER SPECIFICATIONS WITHOUT NOTICE.

Bauer Style - Type B

TYPE B



Bauer Locking Lever

Part Number	Size
BLL-300	3"
BLL-400	4"
BLL-600	6"
BLL-800	8"
BLL-1000	10"
BLL-1200	12"



Bauer O-Ring

Part Number	Size
BLG-300	3"
BLG-400	4"
BLG-600	6"
BLG-800	8"
BLG-1000	10"
BLG-1200	12"



Female Ball Cap

Part Number	Size
BLEC-400	4"
BLEC-600	6"
BLEC-800	8"
BLEC-1000	10"
BLEC-1200	12"



Male End Cap

Part Number	Size
BLEP-400	4"
BLEP-600	6"
BLEP-800	8"
BLEP-1000	10"
BLEP-1200	12"

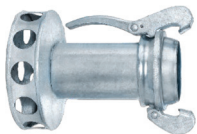

Male Ball x Round Hole Strainer

Part Number	Size
BLMS-800	8"
BLMS-1000	10"
BLMS-1200	12"



Female Socket x Round Hole Strainer

Part Number	Size
BLFS-800	8"
BLFS-1000	10"
BLFS-1200	12"

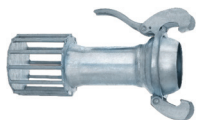

Male Ball x Sewer Screen

Part Number	Size
BLMSCR-400	4"
BLMSCR-600	6"
BLMSCR-800	8"

BECAUSE WE CONTINUALLY EXAMINE WAYS TO IMPROVE OUR PRODUCTS, WE RESERVE THE RIGHT TO ALTER SPECIFICATIONS WITHOUT NOTICE.

TYPE A



Female Socket x Shank

Part Number	Size
BLSS-1000-A	10"
BLSS-1200-A	12"



Male Ball x Shank

Part Number	Size
BLBS-1000-A	10"
BLBS-1200-A	12"



Female Socket x ANSI Flange

Part Number	Size
BLSFL-1000-A	10"
BLSFL-1200-A	12"



Male Ball x ANSI Flange

Part Number	Size
BLBFL-1000-A	10"
BLBFL-1200-A	12"



Male Ball x Female Socket 45°

Part Number	Size
BLEL45-1000-A	10"
BLEL45-1200-A	12"



Male Ball x Female Socket 90°

Part Number	Size
BLEL90-1000-A	10"
BLEL90-1200-A	12"



Female End Cap

Part Number	Size
BLEC-1000-A	10"
BLEC-1200-A	12"



Bauer O-Ring

Part Number	Size
BLG-1000-A	10"
BLG-1200-A	12"



Male End Plug

Part Number	Size
BELP1000-A	10"
BELP1200-A	12"

BECAUSE WE CONTINUALLY EXAMINE WAYS TO IMPROVE OUR PRODUCTS, WE RESERVE THE RIGHT TO ALTER SPECIFICATIONS WITHOUT NOTICE.