

## 0304C JIC Cap

SAE# 070112

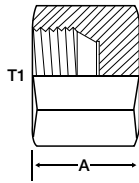

Part Number	T1
	FJIC
0304C-02	5/16 - 24
0304C-03	3/8 - 24
0304C-04	7/16 - 20
0304C-05	1/2 - 20
0304C-06	9/16 - 18
0304C-08	3/4 - 16
0304C-10	7/8 - 14
0304C-12	1 1/16 - 12
0304C-14	1 3/16 - 12
0304C-16	1 5/16 - 12
0304C-20	1 5/8 - 12
0304C-24	1 7/8 - 12
0304C-32	2 1/2 - 12

## 0306 JIC Bulkhead Locknut

SAE# 51860

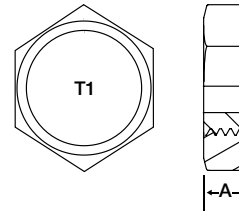

Part Number	T1
	FJIC
0306-03	3/8 - 24
0306-04	7/16 - 20
0306-05	1/2 - 20
0306-06	9/16 - 18
0306-08	3/4 - 16
0306-10	7/8 - 14
0306-12	1 1/16 - 12
0306-14	1 3/16 - 12
0306-16	1 5/16 - 12
0306-20	1 5/8 - 12
0306-24	1 7/8 - 1
0306-32	2 1/2 - 12

## 0318 JIC Tube Nut

SAE# 070110

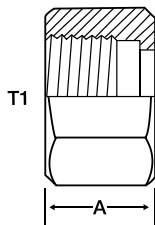

Part Number	T1	Tube OD
	FJIC	
0318-02	5/16 - 24	1/8
0318-03	3/8 - 24	3/16
0318-04	7/16 - 20	1/4
0318-05	1/2 - 20	5/16
0318-06	9/16 - 18	3/8
0318-08	3/4 - 16	1/2
0318-10	7/8 - 14	5/8
0318-12	1 1/16 - 12	3/4
0318-14	1 3/16 - 12	3/4
0318-16	1 5/16 - 12	7/8
0318-20	1 5/8 - 12	1
0318-24	1 7/8 - 12	1 1/2
0318-32	2 1/2 - 12	2

## 0319 JIC Tube Sleeve

SAE# 070115

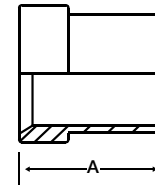

Part Number	Tube OD
0319-02	1/8
0319-03	3/16
0319-04	1/4
0319-05	5/16
0319-06	3/8
0319-08	1/2
0319-10	5/8
0319-12	3/4
0319-14	7/8
0319-16	1
0319-20	1 1/4
0319-24	1 1/2
0319-32	2

BECAUSE WE CONTINUALLY EXAMINE WAYS TO IMPROVE OUR PRODUCTS, WE RESERVE THE RIGHT TO ALTER SPECIFICATIONS WITHOUT NOTICE.

# JIC and Pipe

## 0403 BORE - MJ Straight

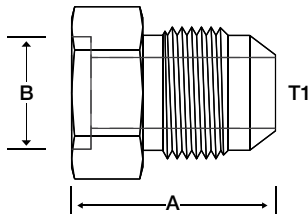

Part Number	B	T1
	BORE	MJIC
0403-0404	1/4	7/16 - 20
0403-0505	5/16	1/2 - 20
0403-0606	3/8	9/16 - 18
0403-0608	3/8	3/4 - 16
0403-0808	1/2	3/4 - 16
0403-1010	5/8	7/8 - 14
0403-1212	3/4	1 1/16 - 12
0403-1414	7/8	1 3/16 - 12
0403-1616	1	1 5/16 - 12
0403-1620	1	1 5/8 - 12
0403-2016	1 1/4	1 5/16 - 12
0403-2020	1 1/4	1 5/8 - 12
0403-2424	1 1/2	1 7/8 - 12
0403-3232	2	2 1/2 - 12

## 1404 MP - FPX Straight

SAE# 140130

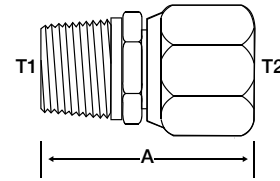

Part Number	T1	T2
	MNPT	FNPSM
1404-0204	1/8 - 27	1/4 - 1
1404-0402	1/4 - 18	1/8 - 27
1404-0404	1/4 - 18	1/4 - 18
1404-0406	1/4 - 18	3/8 - 18
1404-0604	3/8 - 18	1/4 - 18
1404-0606	3/8 - 18	3/8 - 18
1404-0608	3/8 - 18	1/2 - 14
1404-0804	1/2 - 14	1/2 - 18
1404-0806	1/2 - 14	3/8 - 18
1404-0808	1/2 - 14	1/2 - 14
1404-0812	1/2 - 14	3/4 - 14
1404-1208	3/4 - 14	1/2 - 14
1404-1212	3/4 - 14	3/4 - 14
1404-1216	3/4 - 14	1 - 11 1/2
1404-1612	1 - 11 1/2	3/4 - 14
1404-1616	1 - 11 1/2	1 - 11 1/2
1404-1620	1 - 11 1/2	1 1/4 - 11 1/2
1404-2016	1 1/4 - 11 1/2	1 - 11 1/2
1404-2020	1 1/4 - 11 1/2	1 1/4 - 11 1/2
1404-2024	1 1/4 - 11 1/2	1 1/2 - 11 1/2
1404-2420	1 1/2 - 11 1/2	1 1/4 - 11 1/2
1404-2424	1 1/2 - 11 1/2	1 1/2 - 11 1/2
1404-3232	2 - 11 1/2	2 - 11 1/2

## 1405 FP - FPX Straight

SAE# 140131

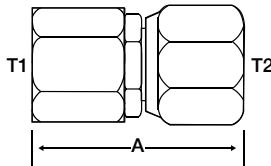

Part Number	T1	T2
	FNPT	FNPSM
1405-0202	1/8 - 27	1/8 - 27
1405-0204	1/8 - 27	1/4 - 18
1405-0404	1/4 - 18	1/4 - 18
1405-0406	1/4 - 18	3/8 - 18
1405-0604	3/8 - 18	1/4 - 18
1405-0606	3/8 - 18	3/8 - 18
1405-0608	3/8 - 18	1/2 - 14
1405-0804	1/2 - 14	1/4 - 18
1405-0806	1/2 - 14	3/8 - 18
1405-0808	1/2 - 14	1/2 - 14
1405-1208	3/4 - 14	1/2 - 14
1405-1212	3/4 - 14	3/4 - 14
1405-1612	1 - 11 1/2	3/4 - 14
1405-1616	1 - 11 1/2	1 - 11 1/2
1405-2020	1 1/4 - 11 1/2	1 1/4 - 11 1/2
1405-2424	1 1/2 - 11 1/2	1 1/2 - 11 1/2
1405-3232	2 - 11 1/2	2 - 11 1/2

BECAUSE WE CONTINUALLY EXAMINE WAYS TO IMPROVE OUR PRODUCTS, WE RESERVE THE RIGHT TO ALTER SPECIFICATIONS WITHOUT NOTICE.

## 1501 MP - FPX 90°

SAE# 140230

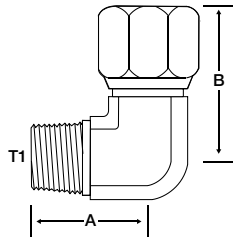

## 1501LL MP - FPX 90° X-Long

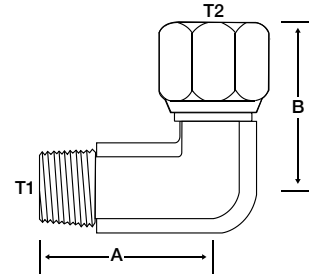

Part Number	T1	T2
	MNPT	FNPSM
1501-0202	1/8 - 27	1/8 - 27
1501-0204	1/8 - 27	1/4 - 18
1501-0402	1/4 - 18	1/8 - 27
1501-0404	1/4 - 18	1/4 - 18
1501-0406	1/4 - 18	3/8 - 18
1501-0408	1/4 - 18	1/2 - 14
1501-0604	3/8 - 18	1/4 - 18
1501-0606	3/8 - 18	3/8 - 18
1501-0608	3/8 - 18	1/2 - 14
1501-0804	1/2 - 14	1/4 - 18
1501-0806	1/2 - 14	3/8 - 18
1501-0808	1/2 - 14	1/2 - 14
1501-0812	1/2 - 14	3/4 - 14
1501-1206	3/4 - 14	3/8 - 18
1501-1208	3/4 - 14	1/2 - 14
1501-1212	3/4 - 14	3/4 - 14
1501-1216	3/4 - 14	1 - 11 1/2
1501-1608	1 - 11 1/2	1/2 - 14
1501-1612	1 - 11 1/2	3/4 - 14
1501-1616	1 - 11 1/2	1 - 11 1/2
1501-1620	1 - 11 1/2	1 1/4 - 11 1/2
1501-2016	1 1/4 - 11 1/2	1 - 11 1/2
1501-2020	1 1/4 - 11 1/2	1 1/4 - 11 1/2
1501-2024	1 1/4 - 11 1/2	1 1/2 - 11 1/2
1501-2420	1 1/2 - 11 1/2	1 1/4 - 11 1/2
1501-2424	1 1/2 - 11 1/2	1 1/2 - 11 1/2
1501-3232	2 - 11 1/2	2 - 11 1/2

Part Number	T1	T2
	MNPT	FNPSM
1501LL-0202	1/8 - 27	1/8 - 27
1501LL-0404	1/4 - 18	1/4 - 18
1501LL-0606	3/8 - 18	3/8 - 18
1501LL-0808	1/2 - 14	1/2 - 14
1501LL-1212	3/4 - 14	3/4 - 14
1501LL-1616	1 - 11 1/2	1 - 11 1/2

BECAUSE WE CONTINUALLY EXAMINE WAYS TO IMPROVE OUR PRODUCTS, WE RESERVE THE RIGHT TO ALTER SPECIFICATIONS WITHOUT NOTICE.

# JIC and Pipe

## 1502 FP - FPX 90°

SAE# 140231

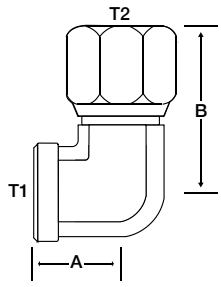

Part Number	T1	T2
	FNPT	FNPSM
1502-0202	1/8 - 27	1/8 - 27
1502-0402	1/4 - 18	1/8 - 27
1502-0404	1/4 - 18	1/4 - 18
1502-0406	1/4 - 18	3/8 - 18
1502-0604	3/8 - 18	1/4 - 18
1502-0606	3/8 - 18	3/8 - 18
1502-0608	3/8 - 18	1/2 - 14
1502-0804	3/4 - 16	1/4 - 18
1502-0806	1/2 - 14	3/8 - 18
1502-0808	1/2 - 14	1/2 - 14
1502-0812	1/2 - 14	3/4 - 14
1502-1208	3/4 - 14	1/2 - 14
1502-1212	3/4 - 14	3/4 - 14
1502-1216	3/4 - 14	1 - 11 1/2
1502-1612	1 - 11 1/2	3/4 - 14
1502-1616	1 - 11 1/2	1 - 11 1/2
1502-2020	1 1/4 - 11 1/2	1 1/4 - 11 1/2
1502-2424	1 1/2 - 11 1/2	1 1/2 - 11 1/2
1502-3232	2 - 11 1/2	2 - 11 1/2

## 1503 MP - FPX 45°

SAE# 140330

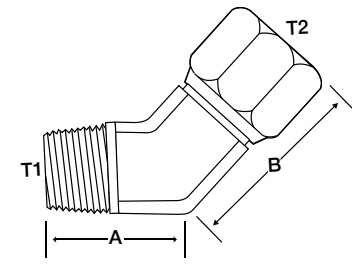

Part Number	T1	T2
	MNPT	FNPSM
1503-0202	1/8 - 27	1/8 - 27
1503-0204	1/8 - 27	1/4 - 18
1503-0404	1/4 - 18	1/4 - 18
1503-0406	1/4 - 18	3/8 - 18
1503-0604	3/8 - 18	1/4 - 18
1503-0606	3/8 - 18	3/8 - 18
1503-0608	3/8 - 18	1/2 - 14
1503-0804	1/2 - 14	1/4 - 18
1503-0806	1/2 - 14	3/8 - 18
1503-0808	1/2 - 14	1/2 - 14
1503-0812	1/2 - 14	3/4 - 14
1503-1208	3/4 - 14	1/2 - 14
1503-1212	3/4 - 14	3/4 - 14
1503-1216	3/4 - 14	1 - 11 1/2
1503-1612	1 - 11 1/2	3/4 - 14
1503-1616	1 - 11 1/2	1 - 11 1/2
1503-1620	1 - 11 1/2	1 1/4 - 11 1/2
1503-2016	1 1/4 - 11 1/2	1 - 11 1/2
1503-2020	1 1/4 - 11 1/2	1 1/4 - 11 1/2
1503-2424	1 1/2 - 11 1/2	1 1/2 - 11 1/2
1503-3232	2 - 11 1/2	2 - 11 1/2

BECAUSE WE CONTINUALLY EXAMINE WAYS TO IMPROVE OUR PRODUCTS, WE RESERVE THE RIGHT TO ALTER SPECIFICATIONS WITHOUT NOTICE.

## 1504 FP - FPX 45°

SAE# 140331

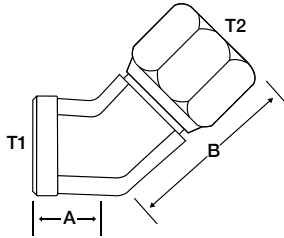

Part Number	T1	T2
	FNPT	FNPSM
1504-0202	1/8 - 27	1/8 - 27
1504-0404	1/4 - 18	1/4 - 18
1504-0604	3/8 - 18	1/4 - 18
1504-0606	3/8 - 18	3/8 - 18
1504-0806	1/2 - 14	3/8 - 18
1504-0808	1/2 - 14	1/2 - 14
1504-1212	3/4 - 14	3/4 - 14
1504-1612	1 - 11 1/2	3/4 - 14
1504-1616	1 - 11 1/2	1 - 11 1/2
1504-2020	1 1/4 - 11 1/2	1 1/4 - 11 1/2
1504-2424	1 1/2 - 11 1/2	1 1/2 - 11 1/2

## 1602 FP - FPX - FPX - Tee

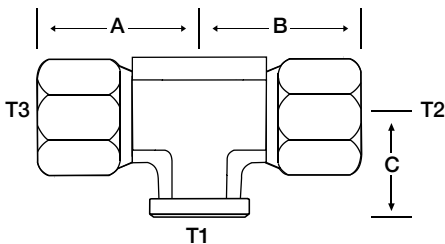

Part Number	T1	T2 / T3
	FNPT	FNPSM
1602-020202	1/8 - 27	1/8 - 27
1602-040404	1/4 - 18	1/4 - 18
1602-060606	3/8 - 18	3/8 - 18
1602-080606	1/2 - 14	3/8 - 18
1602-080808	1/2 - 14	1/2 - 14
1602-120808	3/4 - 14	1/2 - 14
1602-121212	3/4 - 14	3/4 - 14
1602-161616	1 - 11 1/2	1 - 11 1/2
1602-202020	1 1/4 - 11 1/2	1 1/4 - 11 1/2

## 1601 MP - FPX - FPX Tee

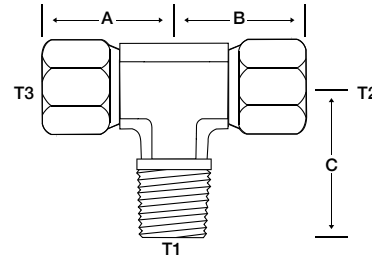

Part Number	T1	T2 / T3
	MNPT	FNPSM
1601-020202	1/8 - 27	1/8 - 27
1601-040404	1/4 - 18	1/4 - 18
1601-040606	1/4 - 18	3/8 - 18
1601-060404	3/8 - 18	1/4 - 18
1601-060606	3/8 - 18	3/8 - 18
1601-080404	1/2 - 14	1/4 - 18
1601-080606	1/2 - 14	3/8 - 18
1601-080808	1/2 - 14	1/2 - 14
1601-120808	3/4 - 14	1/2 - 14
1601-121212	3/4 - 14	3/4 - 14
1601-121616	3/4 - 14	1 - 11 1/2
1601-161212	1 - 11 1/2	3/4 - 14
1601-161616	1 - 11 1/2	1 - 11 1/2
1601-202020	1 1/4 - 11 1/2	1 1/4 - 11 1/2
1601-242424	1 1/2 - 11 1/2	1 1/2 - 11 1/2

## 1603 FPX - FPX - FPX Tee

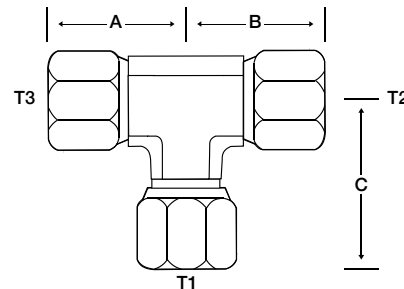

Part Number	T1	T2 / T3
	FNPSM	FNPSM
1603-020202	1/8 - 27	1/8 - 27
1603-040404	1/4 - 18	1/4 - 18
1603-060606	3/8 - 18	3/8 - 18
1603-080808	1/2 - 14	3/4 - 14
1603-121212	3/4 - 14	1 - 11 1/2
1603-161616	1 - 11 1/2	1 1/4 - 11 1/2
1603-202020	1 1/4 - 11 1/2	1 1/4 - 11 1/2

BECAUSE WE CONTINUALLY EXAMINE WAYS TO IMPROVE OUR PRODUCTS, WE RESERVE THE RIGHT TO ALTER SPECIFICATIONS WITHOUT NOTICE.

# JIC and Pipe

## 1700 MJ - Flange (61)

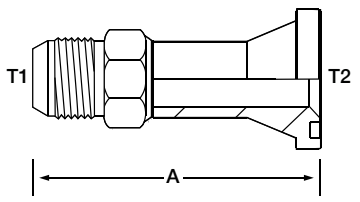

Part Number	T1	T2
	MJIC	Code 61
1700-0808	3/4 - 16	1/2
1700-0812	3/4 - 16	3/4
1700-1212	1 1/16 - 12	3/4
1700-1216	1 1/16 - 12	1
1700-1220	1 1/16 - 12	1 1/4
1700-1612	1 5/16 - 12	3/4
1700-1616	1 5/16 - 12	1
1700-1620	1 5/16 - 12	1 1/4
1700-1624	1 5/16 - 12	1 1/2
1700-2016	1 5/8 - 12	1
1700-2020	1 5/8 - 12	1 1/4
1700-2024	1 5/8 - 12	1 1/2
1700-2032	1 5/8 - 12	2
1700-2420	1 7/8 - 12	1 1/4
1700-2424	1 7/8 - 12	1 1/2
1700-2432	1 7/8 - 12	2
1700-3224	2 1/2 - 12	1 1/2
1700-3232	2 1/2 - 12	2

## 1703 MJ - Flange (61) 45°

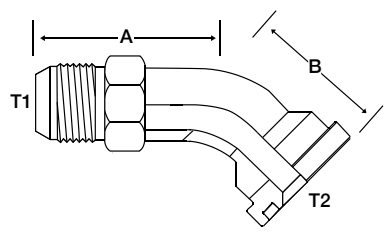

Part Number	T1	T2
	MJIC	Code 61
1703-0808	3/4 - 16	1/2
1703-0812	3/4 - 16	3/4
1703-1212	1 1/16 - 12	3/4
1703-1216	1 1/16 - 12	1
1703-1220	1 1/16 - 12	1 1/4
1703-1612	1 5/16 - 12	3/4
1703-1616	1 5/16 - 12	1
1703-1620	1 5/16 - 12	1 1/4
1703-1624	1 5/16 - 12	1 1/2
1703-2012	1 5/8 - 12	3/4
1703-2016	1 5/8 - 12	1
1703-2020	1 5/8 - 12	1 1/4
1703-2024	1 5/8 - 12	1 1/2
1703-2420	1 7/8 - 12	1 1/4
1703-2424	1 7/8 - 12	1 1/2
1703-2432	1 7/8 - 12	2
1703-3232	2 1/2 - 12	2

## 1703FG MJ - Flange (61) 45° Forged

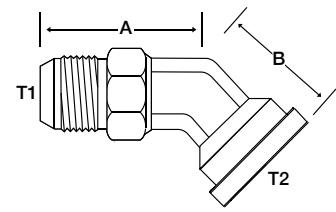

Part Number	T1	T2
	MJIC	Code 61
1703-1212FG	1 1/16 - 12	3/4
1703-1616FG	1 5/16 - 12	1
1703-2020FG	1 5/8 - 12	1 1/4
1703-2424FG	1 7/8 - 12	1 1/2
1703-3232FG	2 1/2 - 12	2

BECAUSE WE CONTINUALLY EXAMINE WAYS TO IMPROVE OUR PRODUCTS, WE RESERVE THE RIGHT TO ALTER SPECIFICATIONS WITHOUT NOTICE.

## 1704 MJ - Flange (61) 90°

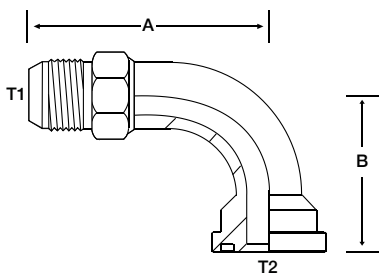

Part Number	T1	T2
	MJIC	Code 61
1704-0808	3/4 - 16	1/2
1704-0812	3/4 - 16	3/4
1704-1212	1 1/16 - 12	3/4
1704-1216	1 1/16 - 12	1
1704-1220	1 1/16 - 12	1 1/4
1704-1612	1 5/16 - 12	3/4
1704-1616	1 5/16 - 12	1
1704-1620	1 5/16 - 12	1 1/4
1704-1624	1 5/16 - 12	1 1/2
1704-2016	1 5/8 - 12	1
1704-2020	1 5/8 - 12	1 1/4
1704-2024	1 5/8 - 12	1 1/2
1704-2420	1 7/8 - 12	1 1/4
1704-2424	1 7/8 - 12	1 1/2
1704-2432	1 7/8 - 12	2
1704-3224	2 1/2 - 12	1 1/2
1704-3232	2 1/2 - 12	2

## 1704FG MJ - Flange (61) 90° Forged

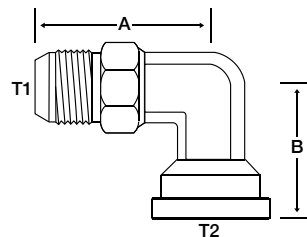

Part Number	T1	T2
	MJIC	Code 61
1704-0812FG	3/4 - 16	3/4
1704-1212FG	1 1/16 - 12	3/4
1704-1216FG	1 1/16 - 12	1
1704-1612FG	1 5/16 - 12	3/4
1704-1616FG	1 5/16 - 12	1
1704-1620FG	1 5/16 - 12	1 1/4
1704-2016FG	1 5/8 - 12	1
1704-2020FG	1 5/8 - 12	1 1/4
1704-2024FG	1 5/8 - 12	1 1/2
1704-2424FG	1 7/8 - 12	1 1/2
1704-2432FG	1 7/8 - 12	2
1704-3224FG	2 1/2 - 12	1 1/2
1704-3232FG	2 1/2 - 12	2

## 1724 Flange (61) Plug

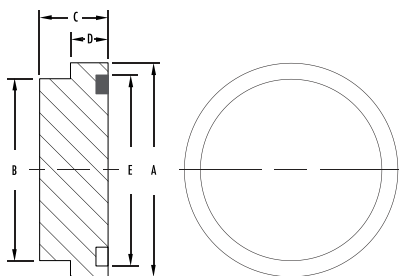

Part Number	A	B	D
1724-08	1.188	.924	.265
1724-12	1.500	1.234	.265
1724-16	1.750	1.484	.315
1724-20	2.000	1.684	.315
1724-24	2.375	1.964	.315
1724-32	2.810	2.434	.375
1724-40	3.312	2.904	.375
1724-48	4.000	3.534	.375

## 1800 MJ - Flange (62)

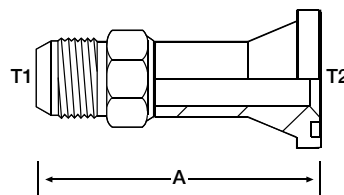

Part Number	T1	T2
	MJIC	Code 61
1800-0808	3/4 - 16	1/2
1800-1212	1 1/16 - 12	3/4
1800-1216	1 1/16 - 12	1
1800-1612	1 5/16 - 12	3/4
1800-1616	1 5/16 - 12	1
1800-1620	1 5/16 - 12	1 1/4
1800-1624	1 5/16 - 12	1 1/2
1800-2016	1 5/8 - 12	1
1800-2020	1 5/8 - 12	1 1/4
1800-2024	1 5/8 - 12	1 1/2
1800-2420	1 7/8 - 12	1 1/4
1800-2424	1 7/8 - 12	1 1/2
1800-3232	2 1/2 - 12	2

BECAUSE WE CONTINUALLY EXAMINE WAYS TO IMPROVE OUR PRODUCTS, WE RESERVE THE RIGHT TO ALTER SPECIFICATIONS WITHOUT NOTICE.

# JIC and Pipe

## 1803 MJ - Flange (62) 45°

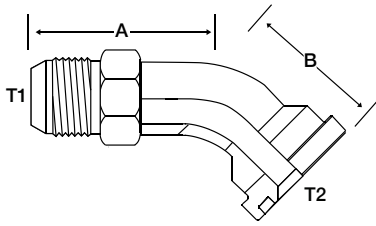

Part Number	T1	T2
	MJIC	Code 62
1803-0808	3/4 - 16	1/2
1803-1212	1 1/16 - 12	3/4
1803-1216	1 1/16 - 12	1
1803-1612	1 5/16 - 12	3/4
1803-1616	1 5/16 - 12	1
1803-1620	1 5/16 - 12	1 1/4
1803-1624	1 5/16 - 12	1 1/2
1803-2016	1 5/8 - 12	1
1803-2020	1 5/8 - 12	1 1/4
1803-2024	1 5/8 - 12	1 1/2
1803-2424	1 7/8 - 12	1 1/2
1803-3232	2 1/2 - 12	2

## 1804 MJ - Flange (62) 90°

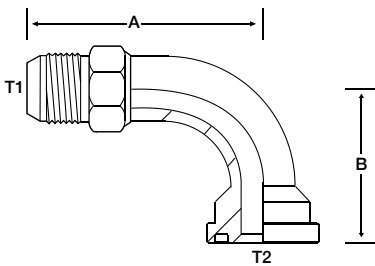

Part Number	T1	T2
	MJIC	Code 62
1804-0808	3/4 - 16	1/2
1804-1212	1 1/16 - 12	3/4
1804-1616	1 5/16 - 12	1
1804-1620	1 5/16 - 12	1 1/4
1804-1624	1 5/16 - 12	1 1/2
1804-2016	1 5/8 - 12	1
1804-2020	1 5/8 - 12	1 1/4
1804-2024	1 5/8 - 12	1 1/2
1804-2416	1 7/8 - 12	1
1804-2420	1 7/8 - 12	1 1/4
1804-2424	1 7/8 - 12	1 1/2
1804-3232	2 1/2 - 12	2

## 1803FG MJ - Flange (62) 45° Forged

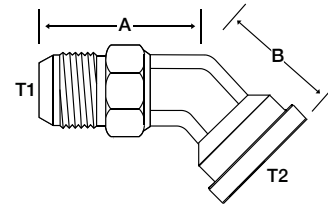

Part Number	T1	T2
	MJIC	Code 62
1803-1212FG	1 1/16 - 12	3/4
1803-1616FG	1 5/16 - 12	1
1803-2020FG	1 5/8 - 12	1 1/4
1803-2424FG	1 7/8 - 12	1 1/2
1803-3232FG	2 1/2 - 12	2

## 1804FG MJ - Flange (62) 90° Forged

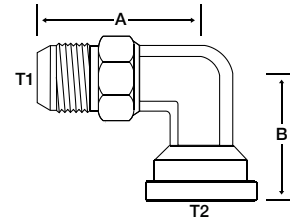

Part Number	T1	T2
	MJIC	Code 62
1804-0808FG	3/4 - 16	1/2
1804-0812FG	3/4 - 16	3/4
1804-1212FG	1 1/16 - 12	3/4
1804-1216FG	1 1/16 - 12	1
1804-1612FG	1 5/16 - 12	3/4
1804-1616FG	1 5/16 - 12	1
1804-1620FG	1 5/16 - 12	1 1/4
1804-2016FG	1 5/8 - 12	1
1804-2020FG	1 5/8 - 12	1 1/4
1804-2024FG	1 5/8 - 12	1 1/2
1804-2420FG	1 7/8 - 12	1 1/4
1804-2424FG	1 7/8 - 12	1 1/2
1804-2432FG	1 7/8 - 12	2
1804-3224FG	2 1/2 - 12	1 1/2
1804-3232FG	2 1/2 - 12	2

BECAUSE WE CONTINUALLY EXAMINE WAYS TO IMPROVE OUR PRODUCTS, WE RESERVE THE RIGHT TO ALTER SPECIFICATIONS WITHOUT NOTICE.



## 1824 Flange (62) Plug

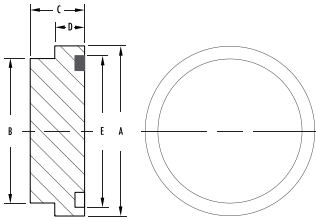

Part Number	A	B	D
1824-12	1.625	1.234	.345
1824-16	1.875	1.484	.375
1824-20	2.125	1.704	.405
1824-24	2.500	1.984	.495
1824-32	3.125	2.604	.495

## 1850 MJ - Flange CAT

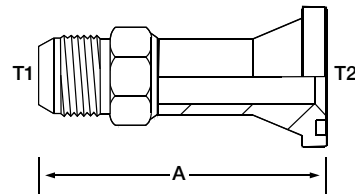

Part Number	T1	T2
	MJIC	CAT
1850-1212	1 <sup>1</sup> / <sub>16</sub> - 12	3/4
1850-1616	1 <sup>1</sup> / <sub>16</sub> - 12	1
1850-2020	1 <sup>5</sup> / <sub>16</sub> - 12	1 <sup>1</sup> / <sub>4</sub>
1850-2424	1 <sup>7</sup> / <sub>16</sub> - 12	1 <sup>1</sup> / <sub>2</sub>

## 1901 Split Flange Kit (61)

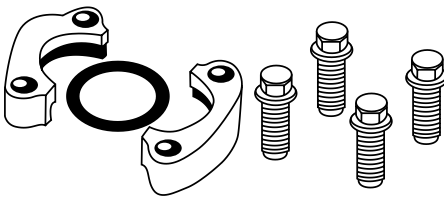

Part Number	Size
	Code 61
1901-08-K	1/2
1901-12-K	3/4
1901-16-K	1
1901-20-K	1 <sup>1</sup> / <sub>4</sub>
1901-24-K	1 <sup>1</sup> / <sub>2</sub>
1901-32-K	2
1901-40-K	2 <sup>1</sup> / <sub>2</sub>
1901-48-K	3
1901-56-K	3 <sup>1</sup> / <sub>2</sub>
1901-64-K	4

## 1902 Split Flange Kit (62)

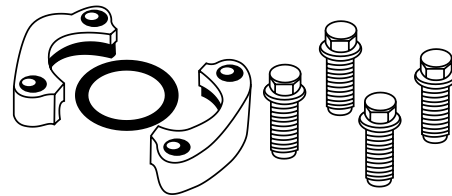

Part Number	Size
	Code 62
1902-08-K	1/2
1902-12-K	3/4
1902-16-K	1
1902-20-K	1 <sup>1</sup> / <sub>4</sub>
1902-24-K	1 <sup>1</sup> / <sub>2</sub>
1902-32-K	2

## 1903 Split Flange Kit (Cat)

D-ring not included.

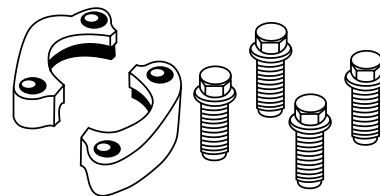

Part Number	Size
	CAT
1903-08-K	1/2
1903-12-K	3/4
1903-16-K	1
1903-20-K	1 <sup>1</sup> / <sub>4</sub>
1903-24-K	1 <sup>1</sup> / <sub>2</sub>
1903-32-K	2

BECAUSE WE CONTINUALLY EXAMINE WAYS TO IMPROVE OUR PRODUCTS, WE RESERVE THE RIGHT TO ALTER SPECIFICATIONS WITHOUT NOTICE.

# JIC and Pipe

## 1927 FP - Flange Kit (61)

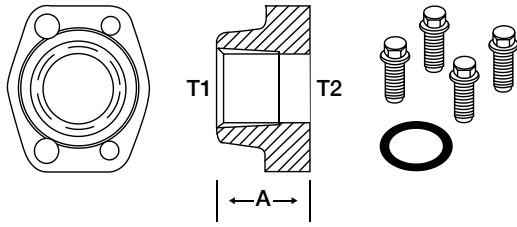

Part Number	T1	T2
	FNPT	Code 61
1927-1212-K	3/4 - 14	3/4
1927-1616-K	1 - 11 1/2	1
1927-2020-K	1 1/4 - 11 1/2	1 1/4
1927-2424-K	1 1/2 - 11 1/2	1 1/2
1927-3232-K	2 - 11 1/2	2
1927-4040-K	2 1/2 - 8	2 1/2
1927-4848-K	3 - 8	3
1927-6464-K	4 - 8	4

## 1928 FP - Flange Kit (62)

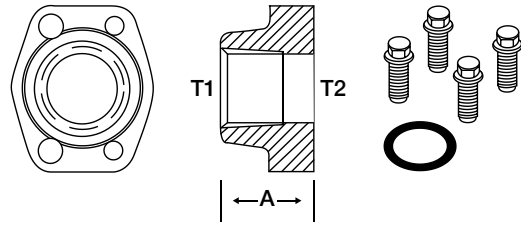

Part Number	T1	T2
	FNPT	Code 62
1928-1212-K	3/4 - 14	3/4
1928-1616-K	1 - 11 1/2	1
1928-2020-K	1 1/4 - 11 1/2	1 1/4
1928-2424-K	1 1/2 - 11 1/2	1 1/2
1928-3232-K	2 - 11 1/2	2
1928-4040-K	2 1/2 - 8	2 1/2
1928-4848-K	3 - 8	3

## 1929-61 FORB - Flange Kit (61)

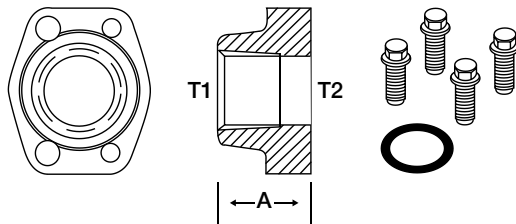

Part Number	T1	T2
	FORB	Code 61
1929-61-1212-K	1 1/16 - 12	3/4
1929-61-1616-K	1 5/16 - 12	1
1929-61-2020-K	1 5/8 - 12	1 1/4
1929-61-2424-K	1 7/8 - 12	1 1/2
1929-61-3232-K	2 1/2 - 12	2

## 1929-62 FORB - Flange Kit (62)

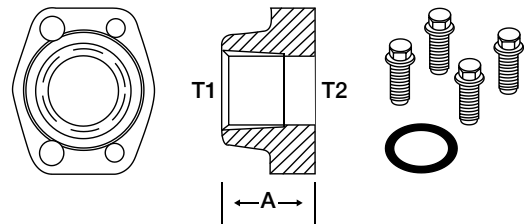

Part Number	T1	T2
	FORB	Code 62
1929-62-1212-K	1 1/16 - 12	3/4
1929-62-1616-K	1 5/16 - 12	1
1929-62-2020-K	1 5/8 - 12	1 1/4
1929-62-2424-K	1 7/8 - 12	1 1/2
1929-62-3232-K	2 1/2 - 12	2

BECAUSE WE CONTINUALLY EXAMINE WAYS TO IMPROVE OUR PRODUCTS, WE RESERVE THE RIGHT TO ALTER SPECIFICATIONS WITHOUT NOTICE.

## 2403 MJ - MJ

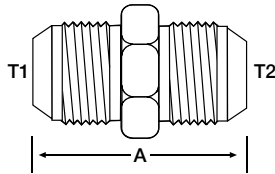

Part Number	T1	T2
	MJIC	MJIC
2403-0202	5/16 - 24	5/16 - 24
2403-0303	3/8 - 24	3/8 - 24
2403-0402	7/16 - 20	5/16 - 24
2403-0404	7/16 - 20	7/16 - 20
2403-0505	1/2 - 20	1/2 - 20
2403-0604	9/16 - 18	7/16 - 20
2403-0606	9/16 - 18	9/16 - 18
2403-0804	3/4 - 16	7/16 - 20
2403-0806	3/4 - 16	9/16 - 18
2403-0808	3/4 - 16	3/4 - 16
2403-1004	7/8 - 14	7/16 - 20
2403-1006	7/8 - 14	9/16 - 18
2403-1008	7/8 - 14	3/4 - 16
2403-1010	7/8 - 14	7/8 - 14
2403-1208	1 1/16 - 12	3/4 - 16
2403-1210	1 1/16 - 12	7/8 - 14
2403-1212	1 1/16 - 12	1 1/16 - 12
2403-1414	1 3/16 - 12	1 3/16 - 12
2403-1608	1 5/16 - 12	3/4 - 16
2403-1610	1 5/16 - 12	7/8 - 14
2403-1612	1 5/16 - 12	1 1/16 - 12
2403-1616	1 5/16 - 12	1 5/16 - 12
2403-2012	1 5/8 - 12	1 1/16 - 12
2403-2016	1 5/8 - 12	1 5/16 - 12
2403-2020	1 5/8 - 12	1 5/8 - 12
2403-2412	1 7/8 - 12	1 1/16 - 12
2403-2416	1 7/8 - 12	1 5/16 - 12
2403-2420	1 7/8 - 12	1 5/8 - 12
2403-2424	1 7/8 - 12	1 7/8 - 12
2403-3232	2 1/2 - 12	2 1/2 - 12

## 2403LH MJ - MJ Large Hex

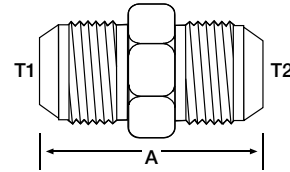

Part Number	T1	T2
	MJIC	MJIC
2403LH-0404	7/16 - 20	7/16 - 20
2403LH-0606	9/16 - 18	9/16 - 18
2403LH-0808	3/4 - 16	3/4 - 16
2403LH-1212	1 1/16 - 12	1 1/16 - 12
2403LH-1616	1 5/16 - 12	1 5/16 - 12
2403LH-2020	1 5/8 - 12	1 5/8 - 12

## 2404 MJ - MP Straight

SAE# 070102

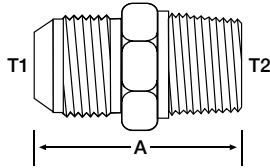

Part Number	T1	T2
	MJIC	MNPT
2404-0202	5/16 - 24	1/8 - 27
2404-0204	5/16 - 24	1/4 - 18
2404-0302	3/8 - 24	1/8 - 27
2404-0402	7/16 - 20	1/8 - 27
2404-0404	7/16 - 20	1/4 - 18
2404-0406	7/16 - 20	3/8 - 18
2404-0408	7/16 - 20	1/2 - 14
2404-0502	1/2 - 20	1/8 - 27
2404-0504	1/2 - 20	1/4 - 18
2404-0506	1/2 - 20	3/8 - 18
2404-0602	9/16 - 18	1/8 - 27
2404-0604	9/16 - 18	1/4 - 18
2404-0606	9/16 - 18	3/8 - 18
2404-0608	9/16 - 18	1/2 - 14
2404-0612	9/16 - 18	3/4 - 14
2404-0802	3/4 - 16	1/8 - 27
2404-0804	3/4 - 16	1/4 - 18
2404-0806	3/4 - 16	3/8 - 18
2404-0808	3/4 - 16	1/2 - 14
2404-0812	3/4 - 16	3/4 - 14
2404-0816	3/4 - 16	1 - 11 1/2
2404-1004	7/8 - 14	1/4 - 18
2404-1006	7/8 - 14	3/8 - 18
2404-1008	7/8 - 14	1/2 - 14
2404-1012	7/8 - 14	3/4 - 14
2404-1206	1 1/16 - 12	3/8 - 18
2404-1208	1 1/16 - 12	1/2 - 14
2404-1212	1 1/16 - 12	3/4 - 14
2404-1216	1 1/16 - 12	1 - 11 1/2
2404-1220	1 1/16 - 12	1 1/4 - 11 1/2
2404-1224	1 1/16 - 12	1 1/2 - 11 1/2
2404-1408	1 3/16 - 12	1/2 - 14
2404-1412	1 3/16 - 12	3/4 - 14
2404-1608	1 5/16 - 12	1/2 - 14

Part Number	T1	T2
	MJIC	MNPT
2404-1612	1 5/16 - 12	3/4 - 14
2404-1616	1 5/16 - 12	1 - 11 1/2
2404-1620	1 5/16 - 12	1 1/4 - 11 1/2
2404-1624	1 5/16 - 12	1 1/2 - 11 1/2
2404-2012	1 5/8 - 12	3/4 - 14
2404-2016	1 5/8 - 12	1 - 11 1/2
2404-2020	1 5/8 - 12	1 1/4 - 11 1/2
2404-2024	1 5/8 - 12	1 1/2 - 11 1/2
2404-2032	1 5/8 - 12	2 - 11 1/2
2404-2416	1 7/8 - 12	1 - 11 1/2
2404-2420	1 7/8 - 12	1 1/4 - 11 1/2
2404-2424	1 7/8 - 12	1 1/2 - 11 1/2
2404-2432	1 7/8 - 12	2 - 11 1/2
2404-3220	2 1/2 - 12	1 1/4 - 11 1/2
2404-3224	2 1/2 - 12	1 1/2 - 11 1/2
2404-3232	2 1/2 - 12	2 - 11 1/2

BECAUSE WE CONTINUALLY EXAMINE WAYS TO IMPROVE OUR PRODUCTS, WE RESERVE THE RIGHT TO ALTER SPECIFICATIONS WITHOUT NOTICE.

## 2404L MJ - MP Long

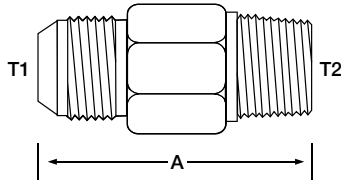

Part Number	T1	T2
	MJIC	MNPT
2404L-0402	7/16 - 20	1/8 - 27
2404L-0404	7/16 - 20	1/4 - 18
2404L-0502	1/2 - 20	1/8 - 27
2404L-0504	1/2 - 20	1/4 - 18
2404L-0602	9/16 - 18	1/8 - 27
2404L-0604	9/16 - 18	1/4 - 18
2404L-0606	9/16 - 18	3/8 - 18
2404L-0608	9/16 - 18	1/2 - 14
2404L-0804	3/4 - 16	1/4 - 18
2404L-0806	3/4 - 16	3/8 - 18
2404L-0808	3/4 - 16	1/2 - 14
2404L-1008	7/8 - 14	1/2 - 14
2404L-1212	1 1/16 - 12	3/4 - 14
2404L-1612	1 5/16 - 12	3/4 - 14
2404L-1616	1 5/16 - 12	1 - 11 1/2
2404L-2020	1 5/8 - 12	1 1/4 - 11 1/2
2404L-2424	1 7/8 - 12	1 1/2 - 11 1/2
2404L-3232	2 1/2 - 12	2 - 11 1/2

## 2405 MJ - FP Straight

SAE# 070103

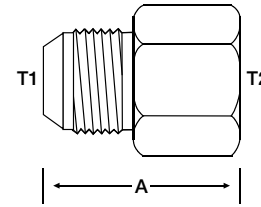

Part Number	T1	T2
	MJIC	FNPT
2405-0202	5/16 - 24	1/8 - 27
2405-0302	3/8 - 24	1/8 - 27
2405-0402	7/16 - 20	1/8 - 27
2405-0404	7/16 - 20	1/4 - 18
2405-0406	7/16 - 20	3/8 - 18
2405-0408	7/16 - 20	1/2 - 14
2405-0502	1/2 - 20	1/8 - 27
2405-0504	1/2 - 20	1/4 - 18
2405-0602	9/16 - 18	1/8 - 27
2405-0604	9/16 - 18	1/4 - 18
2405-0606	9/16 - 18	3/8 - 18
2405-0608	9/16 - 18	1/2 - 14
2405-0804	3/4 - 16	1/4 - 18
2405-0806	3/4 - 16	3/8 - 18
2405-0808	3/4 - 16	1/2 - 14
2405-0812	3/4 - 16	3/4 - 14
2405-1006	7/8 - 14	3/8 - 18
2405-1008	7/8 - 14	1/2 - 14
2405-1012	7/8 - 14	3/4 - 14
2405-1016	7/8 - 14	1 - 11 1/2
2405-1208	1 1/16 - 12	1/2 - 14
2405-1212	1 1/16 - 12	3/4 - 14
2405-1216	1 1/16 - 12	1 - 11 1/2
2405-1412	1 3/16 - 12	3/4 - 14
2405-1612	1 5/16 - 12	3/4 - 14
2405-1616	1 5/16 - 12	1 - 11 1/2
2405-1620	1 5/8 - 12	1 1/4 - 11 1/2
2405-2016	1 5/8 - 12	1 - 11 1/2
2405-2020	1 5/8 - 12	1 1/4 - 11 1/2
2405-2024	1 5/8 - 12	1 1/2 - 11 1/2
2405-2420	1 7/8 - 12	1 1/4 - 11 1/2
2405-2424	1 7/8 - 12	1 1/2 - 11 1/2
2405-3232	2 1/2 - 12	2 - 11 1/2

## 2404LL MJ - MP X-Long

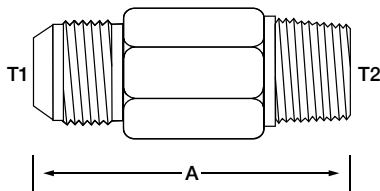

Part Number	T1	T2
	MJIC	MNPT
2404LL-0402	7/16 - 20	1/8 - 27
2404LL-0404	7/16 - 20	1/4 - 18
2404LL-0502	1/2 - 20	1/8 - 27
2404LL-0604	9/16 - 18	1/4 - 18
2404LL-0606	9/16 - 18	3/8 - 18
2404LL-0806	3/4 - 16	3/8 - 18
2404LL-0808	3/4 - 16	1/2 - 14
2404LL-1008	7/8 - 14	1/2 - 14
2404LL-1212	1 1/16 - 12	3/4 - 14
2404LL-1616	1 5/16 - 12	1 - 11 1/2

BECAUSE WE CONTINUALLY EXAMINE WAYS TO IMPROVE OUR PRODUCTS, WE RESERVE THE RIGHT TO ALTER SPECIFICATIONS WITHOUT NOTICE.

# JIC and Pipe

## 2406 FJ - MJ Straight

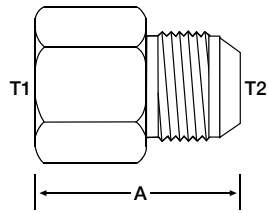

## 2408 MJ Plug

SAE# 070109

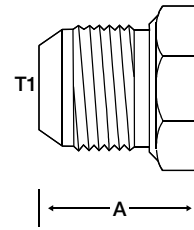

Part Number	T1	T2
	FJIC	MJIC
2406-0402	7/16 - 20	5/16 - 24
2406-0406	7/16 - 20	9/16 - 18
2406-0408	7/16 - 20	3/4 - 16
2406-0604	9/16 - 18	7/16 - 20
2406-0608	9/16 - 18	3/4 - 16
2406-0804	3/4 - 16	7/16 - 20
2406-0806	3/4 - 16	9/16 - 18
2406-0810	3/4 - 16	7/8 - 14
2406-0812	3/4 - 16	1 1/16 - 12
2406-1004	7/8 - 14	7/16 - 20
2406-1006	7/8 - 14	9/16 - 18
2406-1008	7/8 - 14	3/4 - 16
2406-1012	7/8 - 14	1 1/16 - 12
2406-1204	1 1/16 - 12	7/16 - 20
2406-1206	1 1/16 - 12	9/16 - 18
2406-1208	1 1/16 - 12	3/4 - 16
2406-1210	1 1/16 - 12	7/8 - 14
2406-1216	1 1/16 - 12	1 5/16 - 12
2406-1406	1 3/16 - 12	9/16 - 18
2406-1408	1 3/16 - 12	3/4 - 16
2406-1410	1 3/16 - 12	7/8 - 14
2406-1412	1 3/16 - 12	1 1/16 - 12
2406-1604	1 5/16 - 12	7/16 - 20
2406-1606	1 5/16 - 12	9/16 - 18
2406-1608	1 5/16 - 12	3/4 - 16
2406-1610	1 5/16 - 12	7/8 - 14
2406-1612	1 5/16 - 12	1 1/16 - 12
2406-1620	1 5/16 - 12	1 5/8 - 12
2406-1624	1 5/16 - 12	1 7/8 - 12
2406-2012	1 5/8 - 12	1 1/16 - 12
2406-2016	1 5/8 - 12	1 5/16 - 12
2406-2024	1 5/8 - 12	1 7/8 - 12
2406-2416	1 7/8 - 12	1 5/16 - 12
2406-2420	1 7/8 - 12	1 5/8 - 12
2406-2432	1 7/8 - 12	2 1/2 - 12
2406-3224	2 1/2 - 12	1 7/8 - 12

Part Number	T1
	MJIC
2408-02	5/16 - 24
2408-03	3/8 - 24
2408-04	7/16 - 20
2408-05	1/2 - 20
2408-06	9/16 - 18
2408-08	3/4 - 16
2408-10	7/8 - 14
2408-12	1 1/16 - 12
2408-14	1 3/16 - 12
2408-16	1 5/16 - 12
2408-20	1 5/8 - 12
2408-24	1 7/8 - 12
2408-32	2 1/2 - 12

BECAUSE WE CONTINUALLY EXAMINE WAYS TO IMPROVE OUR PRODUCTS, WE RESERVE THE RIGHT TO ALTER SPECIFICATIONS WITHOUT NOTICE.

## 2500 MJ - MJ 90°

SAE# 070201

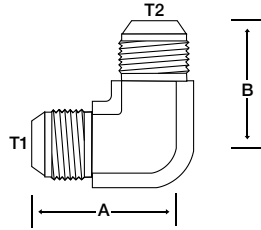

Part Number	T1	T2
	MJIC	MJIC
2500-0202	5/16 - 24	5/16 - 24
2500-0303	3/8 - 24	3/8 - 24
2500-0404	7/16 - 20	7/16 - 20
2500-0504	1/2 - 20	7/16 - 20
2500-0505	1/2 - 20	1/2 - 20
2500-0604	9/16 - 18	7/16 - 20
2500-0605	9/16 - 18	1/2 - 20
2500-0606	9/16 - 18	9/16 - 18
2500-0806	3/4 - 16	9/16 - 18
2500-0808	3/4 - 16	3/4 - 16
2500-1008	7/8 - 14	3/4 - 16
2500-1010	7/8 - 14	7/8 - 14
2500-1208	1 1/16 - 12	3/4 - 16
2500-1210	1 1/16 - 12	7/8 - 14
2500-1212	1 1/16 - 12	1 1/16 - 12
2500-1414	1 3/16 - 12	1 3/16 - 12
2500-1612	1 5/16 - 12	1 1/16 - 12
2500-1616	1 5/16 - 12	1 5/16 - 12
2500-2020	1 5/8 - 12	1 5/8 - 12
2500-2424	1 7/8 - 12	1 7/8 - 12
2500-3232	2 1/2 - 12	2 1/2 - 12

## 2501 MJ - MP 90°

SAE# 51504

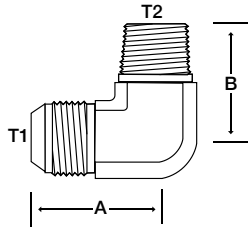

Part Number	T1	T2
	MJIC	MNPT
2501-0202	5/16 - 24	1/8 - 27
2501-0204	5/16 - 24	1/4 - 18
2501-0302	3/8 - 24	1/8 - 27
2501-0402	7/16 - 20	1/8 - 27
2501-0404	7/16 - 20	1/4 - 18
2501-0406	7/16 - 20	3/8 - 18
2501-0408	7/16 - 20	1/2 - 14
2501-0412	7/16 - 20	3/4 - 14
2501-0502	1/2 - 20	1/8 - 27
2501-0504	1/2 - 20	1/4 - 18
2501-0506	1/2 - 20	3/8 - 18
2501-0508	1/2 - 20	1/2 - 14
2501-0602	9/16 - 18	1/8 - 27
2501-0604	9/16 - 18	1/4 - 18
2501-0606	9/16 - 18	3/8 - 18
2501-0608	9/16 - 18	1/2 - 14
2501-0612	9/16 - 18	3/4 - 14
2501-0802	3/4 - 16	1/8 - 27
2501-0804	3/4 - 16	1/4 - 18
2501-0806	3/4 - 16	3/8 - 18
2501-0808	3/4 - 16	1/2 - 14
2501-0812	3/4 - 16	3/4 - 14
2501-0816	3/4 - 16	1 - 11 1/2
2501-1006	7/8 - 14	3/8 - 18
2501-1008	7/8 - 14	1/2 - 14
2501-1012	7/8 - 14	3/4 - 14
2501-1016	7/8 - 14	1/4 - 18
2501-1206	1 1/16 - 12	3/8 - 18
2501-1208	1 1/16 - 12	1/2 - 14
2501-1212	1 1/16 - 12	3/4 - 14
2501-1216	1 1/16 - 12	1 - 11 1/2
2501-1412	1 3/16 - 12	3/4 - 14

Part Number	T1	T2
	MJIC	MNPT
2501-1608	1 5/16 - 12	1/2 - 14
2501-1612	1 5/16 - 12	3/4 - 14
2501-1616	1 5/16 - 12	1 - 11 1/2
2501-1620	1 5/16 - 12	1 1/4 - 11 1/2
2501-1624	1 5/16 - 12	1 1/2 - 11 1/2
2501-2012	1 5/8 - 12	3/4 - 14
2501-2016	1 5/8 - 12	1 - 11 1/2
2501-2020	1 5/8 - 12	1 1/4 - 11 1/2
2501-2024	1 5/8 - 12	1 1/2 - 11 1/2
2501-2416	1 7/8 - 12	1 - 11 1/2
2501-2420	1 7/8 - 12	1 1/4 - 11 1/2
2501-2424	1 7/8 - 12	1 1/2 - 11 1/2
2501-2432	1 7/8 - 12	2 - 11 1/2
2501-3224	2 1/2 - 12	1 1/2 - 11 1/2
2501-3232	2 1/2 - 12	2 - 11 1/2



## 2501L MJ - MP 90° Long

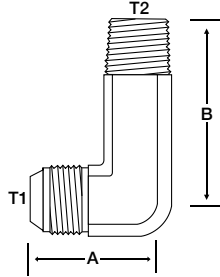

## 2501LL MJ - MP 90° X-Long

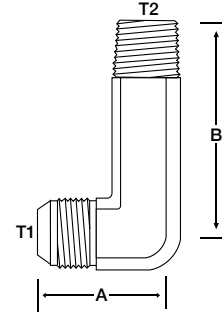

Part Number	T1	T2
	MJIC	MNPT
2501L-0402	7/16 - 20	1/8 - 27
2501L-0404	7/16 - 20	1/4 - 18
2501L-0502	1/2 - 20	1/8 - 27
2501L-0504	1/2 - 20	1/4 - 18
2501L-0602	9/16 - 18	1/8 - 27
2501L-0604	9/16 - 18	1/4 - 18
2501L-0606	9/16 - 18	3/8 - 18
2501L-0608	9/16 - 18	1/2 - 14
2501L-0804	3/4 - 16	1/4 - 18
2501L-0806	3/4 - 16	3/8 - 18
2501L-0808	3/4 - 16	1/2 - 14
2501L-0812	3/4 - 16	3/4 - 14
2501L-1008	7/8 - 14	1/2 - 14
2501L-1212	1 1/16 - 12	3/4 - 14
2501L-1216	1 1/16 - 12	1 - 11 1/2
2501L-1412	1 3/16 - 12	3/4 - 14
2501L-1616	1 5/16 - 12	1 - 11 1/2
2501L-2020	1 5/8 - 12	1 1/4 - 11 1/2
2501L-2424	1 7/8 - 12	1 1/2 - 11 1/2

Part Number	T1	T2
	MJIC	MNPT
2501LL-0402	7/16 - 20	1/8 - 27
2501LL-0404	7/16 - 20	1/4 - 18
2501LL-0406	7/16 - 20	3/8 - 18
2501LL-0502	1/2 - 20	1/8 - 27
2501LL-0504	1/2 - 20	1/4 - 18
2501LL-0604	9/16 - 18	1/4 - 18
2501LL-0606	9/16 - 18	3/8 - 18
2501LL-0608	9/16 - 18	1/2 - 14
2501LL-0806	3/4 - 16	3/8 - 18
2501LL-0808	3/4 - 16	1/2 - 14
2501LL-1008	7/8 - 14	1/2 - 14
2501LL-1208	1 1/16 - 12	1/2 - 14
2501LL-1212	1 1/16 - 12	3/4 - 14
2501LL-1412	1 3/16 - 12	3/4 - 14
2501LL-1616	1 5/16 - 12	1 - 11 1/2
2501LL-2020	1 5/8 - 12	1 1/4 - 11 1/2

# JIC and Pipe

## 2501LLL MJ - MP 90° XX-Long

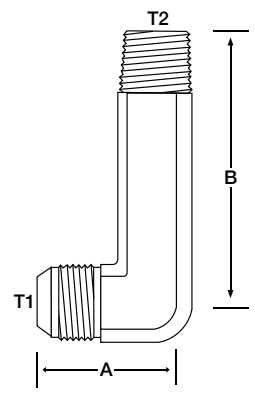

Part Number	T1	T2
	MJIC	MNPT
2501LLL-0402	7/16 - 20	1/8 - 27
2501LLL-0404	7/16 - 20	1/4 - 18
2501LLL-0502	1/2 - 20	1/8 - 27
2501LLL-0604	9/16 - 18	1/4 - 18
2501LLL-0606	9/16 - 18	3/8 - 18
2501LLL-0806	3/4 - 16	3/8 - 18
2501LLL-0808	3/4 - 16	1/2 - 14
2501LLL-1008	7/8 - 14	1/2 - 14
2501LLL-1212	1 1/16 - 12	3/4 - 14
2501LLL-1616	1 5/16 - 12	1 - 11 1/2

## 2502 MJ - FP 90°

SAE# 070203

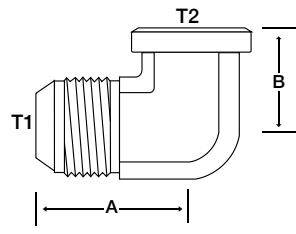

Part Number	T1	T2
	MJIC	FNPT
2502-0202	5/16 - 24	1/8 - 27
2502-0302	3/8 - 24	1/8 - 27
2502-0402	7/16 - 20	1/8 - 27
2502-0404	7/16 - 20	1/4 - 18
2502-0406	7/16 - 20	3/8 - 18
2502-0502	1/2 - 20	1/8 - 27
2502-0504	1/2 - 20	1/4 - 18
2502-0602	9/16 - 18	1/8 - 27
2502-0604	9/16 - 18	1/4 - 18
2502-0606	9/16 - 18	3/8 - 18
2502-0608	9/16 - 18	1/2 - 14
2502-0804	3/4 - 16	1/4 - 18
2502-0806	3/4 - 16	3/8 - 18
2502-0808	3/4 - 16	1/2 - 14
2502-1008	7/8 - 14	1/2 - 14
2502-1208	1 1/16 - 12	1/2 - 14
2502-1212	1 1/16 - 12	3/4 - 14
2502-1412	1 3/16 - 12	3/4 - 14
2502-1612	1 5/16 - 12	3/4 - 14
2502-1616	1 5/16 - 12	1 - 11 1/2
2502-2020	1 5/8 - 12	1 1/4 - 11 1/2
2502-2424	1 7/8 - 12	1 1/2 - 11 1/2
2502-3232	2 1/2 - 12	2 - 11 1/2

BECAUSE WE CONTINUALLY EXAMINE WAYS TO IMPROVE OUR PRODUCTS, WE RESERVE THE RIGHT TO ALTER SPECIFICATIONS WITHOUT NOTICE.

## 2503 MJ - MP 45°

SAE# 070302

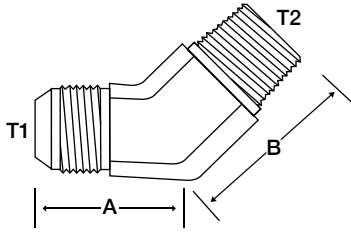

Part Number	T1	T2
	MJIC	MNPT
2503-0202	5/16 - 24	1/8 - 27
2503-0302	3/8 - 24	1/8 - 27
2503-0402	7/16 - 20	1/8 - 27
2503-0404	7/16 - 20	1/4 - 18
2503-0406	7/16 - 20	3/8 - 18
2503-0408	7/16 - 20	1/2 - 14
2503-0502	1/2 - 20	1/8 - 27
2503-0504	1/2 - 20	1/4 - 18
2503-0602	9/16 - 18	1/8 - 27
2503-0604	9/16 - 18	1/4 - 18
2503-0606	9/16 - 18	3/8 - 18
2503-0608	9/16 - 18	1/2 - 14
2503-0612	9/16 - 18	3/4 - 14
2503-0804	3/4 - 16	1/4 - 18
2503-0806	3/4 - 16	3/8 - 18
2503-0808	3/4 - 16	1/2 - 14
2503-0812	3/4 - 16	3/4 - 14
2503-1006	7/8 - 14	3/8 - 18
2503-1008	7/8 - 14	1/2 - 14
2503-1012	7/8 - 14	3/4 - 14
2503-1208	1 1/16 - 12	1/2 - 14
2503-1212	1 1/16 - 12	3/4 - 14
2503-1216	1 1/16 - 12	1 - 11 1/2
2503-1412	1 3/16 - 12	3/4 - 14
2503-1608	1 5/16 - 12	1/2 - 14
2503-1612	1 5/16 - 12	3/4 - 14
2503-1616	1 5/16 - 12	1 - 11 1/2
2503-1620	1 5/16 - 12	1 1/4 - 11 1/2
2503-2016	1 5/8 - 12	1 - 11 1/2
2503-2020	1 5/8 - 12	1 1/4 - 11 1/2
2503-2024	1 5/8 - 12	1 1/2 - 11 1/2
2503-2424	1 7/8 - 12	1 1/2 - 11 1/2
2503-3232	2 1/2 - 12	2 - 11 1/2

## 2504 MJ - MJ 45°

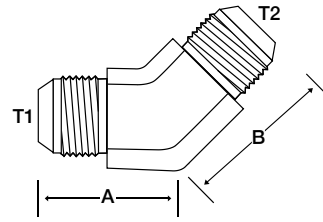

Part Number	T1	T2
	MJIC	MJIC
2504-0404	7/16 - 20	7/16 - 20
2504-0606	9/16 - 18	9/16 - 18
2504-0808	3/4 - 16	3/4 - 16
2504-1010	7/8 - 14	7/8 - 14
2504-1212	1 1/16 - 12	1 1/16 - 12
2504-1616	1 5/16 - 12	1 5/16 - 12

## 2505 MJ - FP 45°

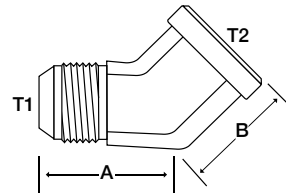

Part Number	T1	T2
	MJIC	FNPT
2505-0404	7/16 - 20	1/4 - 18
2505-0604	9/16 - 18	1/4 - 18
2505-0606	9/16 - 18	3/8 - 18
2505-0806	3/4 - 16	3/8 - 18
2505-0808	3/4 - 16	1/2 - 14
2505-1008	7/8 - 14	1/2 - 14
2505-1212	1 1/16 - 12	3/4 - 14
2505-1616	1 5/16 - 12	1 - 11 1/2

BECAUSE WE CONTINUALLY EXAMINE WAYS TO IMPROVE OUR PRODUCTS, WE RESERVE THE RIGHT TO ALTER SPECIFICATIONS WITHOUT NOTICE.

# JIC and Pipe

**2601 MJ - MJ - MP Tee**  
SAE# 070425

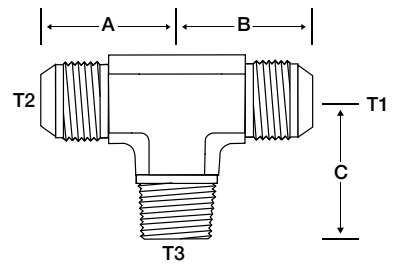

**2602 MJ - MJ - FP Tee**  
SAE# 070427

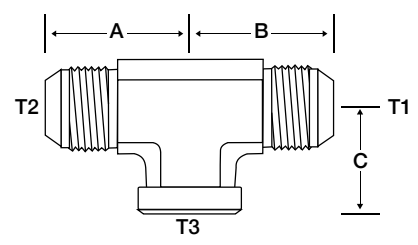

Part Number	T1 / T2	T3
	MJIC	MNPT
2601-030302	3/8 - 24	1/8 - 27
2601-040402	7/16 - 20	1/8 - 27
2601-040404	7/16 - 20	1/4 - 18
2601-040406	7/16 - 20	3/8 - 18
2601-050502	1/2 - 20	1/8 - 27
2601-050504	1/2 - 20	1/4 - 18
2601-060604	9/16 - 18	1/4 - 18
2601-060606	9/16 - 18	3/8 - 18
2601-060608	9/16 - 18	1/2 - 14
2601-080804	3/4 - 16	1/4 - 18
2601-080806	3/4 - 16	3/8 - 18
2601-080808	3/4 - 16	1/2 - 14
2601-101006	7/8 - 14	3/8 - 18
2601-101008	7/8 - 14	1/2 - 14
2601-121208	1 1/16 - 12	1/2 - 14
2601-121212	1 1/16 - 12	3/4 - 14
2601-141412	1 3/16 - 12	3/4 - 14
2601-161612	1 5/16 - 12	3/4 - 14
2601-161616	1 5/16 - 12	1 - 11 1/2
2601-202020	1 5/8 - 12	1 1/4 - 11 1/2
2601-242424	1 7/8 - 12	1 1/2 - 11 1/2
2601-323232	2 1/2 - 12	2 - 11 1/2

Part Number	T1 / T2	T3
	MJIC	FNPT
2602-040402	7/16 - 20	1/8 - 27
2602-040404	7/16 - 20	1/4 - 18
2602-050502	1/2 - 20	1/8 - 27
2602-060604	9/16 - 18	1/4 - 18
2602-060606	9/16 - 18	3/8 - 18
2602-080806	3/4 - 16	3/8 - 18
2602-080808	3/4 - 16	1/2 - 14
2602-101008	7/8 - 14	1/2 - 14
2602-121212	1 1/16 - 12	3/4 - 14
2602-141412	1 3/16 - 12	3/4 - 14
2602-161616	1 5/16 - 12	1 - 11 1/2
2602-202020	1 5/8 - 12	1 1/4 - 11 1/2
2602-242424	1 7/8 - 12	1 1/2 - 11 1/2
2602-323232	2 1/2 - 12	2 - 11 1/2

BECAUSE WE CONTINUALLY EXAMINE WAYS TO IMPROVE OUR PRODUCTS, WE RESERVE THE RIGHT TO ALTER SPECIFICATIONS WITHOUT NOTICE.

## 2603 MJ - MJ - MJ Tee

SAE# 070401

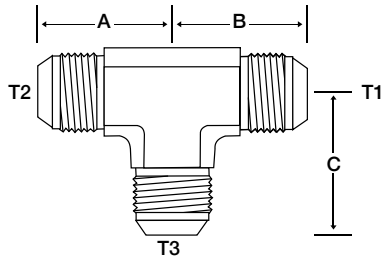

## 2605 MJ - MP - MJ Tee

SAE# 070424

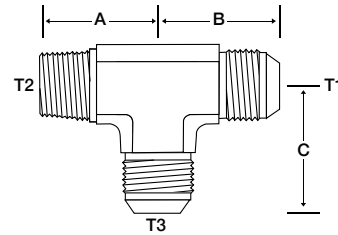

Part Number	T1 / T2	T3
	MJIC	MJIC
2603-020202	5/16 - 24	5/16 - 24
2603-030303	3/8 - 24	3/8 - 24
2603-040404	7/16 - 20	7/16 - 20
2603-040406	7/16 - 20	9/16 - 18
2603-050505	1/2 - 20	1/2 - 20
2603-060604	9/16 - 18	7/16 - 20
2603-060606	9/16 - 18	9/16 - 18
2603-060608	9/16 - 18	3/4 - 16
2603-080808	3/4 - 16	3/4 - 16
2603-080810	3/4 - 16	7/8 - 14
2603-080812	3/4 - 16	1 1/16 - 12
2603-100808	7/8 - 14	3/4 - 16
2603-101008	7/8 - 14	3/4 - 16
2603-101010	7/8 - 14	7/8 - 14
2603-121208	1 1/16 - 12	3/4 - 16
2603-121212	1 1/16 - 12	1 1/16 - 12
2603-121216	1 1/16 - 12	1 5/16 - 12
2603-141414	1 3/16 - 12	1 3/16 - 12
2603-161612	1 5/16 - 12	1 1/16 - 12
2603-161616	1 5/16 - 12	1 5/16 - 12
2603-202020	1 5/8 - 12	1 5/8 - 12
2603-242424	1 7/8 - 12	1 7/8 - 12
2603-323232	2 1/2 - 12	2 1/2 - 12

Part Number	T1 / T3	T2
	MJIC	MNPT
2605-040204	7/16 - 20	1/8 - 27
2605-040404	7/16 - 20	1/4 - 18
2605-050205	1/2 - 20	1/8 - 27
2605-060206	9/16 - 18	1/8 - 27
2605-060404	9/16 - 18	1/4 - 18
2605-060406	9/16 - 18	1/4 - 18
2605-060606	9/16 - 18	3/8 - 18
2605-060806	9/16 - 18	1/2 - 14
2605-080408	3/4 - 16	1/4 - 18
2605-080608	3/4 - 16	3/8 - 18
2605-080808	3/4 - 16	1/2 - 14
2605-100810	7/8 - 14	1/2 - 14
2605-121208	1 1/16 - 12	3/4 - 14
2605-121212	1 1/16 - 12	3/4 - 14
2605-141214	1 3/16 - 12	3/4 - 14
2605-161616	1 5/16 - 12	1 - 11 1/2
2605-202020	1 5/8 - 12	1 1/4 - 11 1/2
2605-242424	1 7/8 - 12	1 1/2 - 11 1/2
2605-323232	2 1/2 - 12	2 - 11 1/2

BECAUSE WE CONTINUALLY EXAMINE WAYS TO IMPROVE OUR PRODUCTS, WE RESERVE THE RIGHT TO ALTER SPECIFICATIONS WITHOUT NOTICE.

# JIC and Pipe

## 2606 MJ - FP - MJ Tee

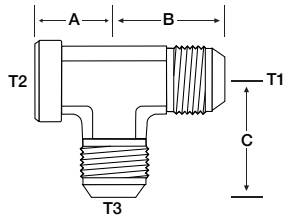

Part Number	T1 / T3	T2
	MJIC	FNPT
2606-040204	7/16 - 20	1/8 - 27
2606-040404	7/16 - 20	1/4 - 18
2606-060406	9/16 - 18	1/4 - 18
2606-060606	9/16 - 18	3/8 - 18
2606-080608	3/4 - 16	3/8 - 18
2606-080808	3/4 - 16	1/2 - 14
2606-100810	7/8 - 14	1/2 - 14
2606-121212	1 1/16 - 12	3/4 - 14
2606-161616	1 5/16 - 12	1 - 11 1/2
2606-202020	1 5/8 - 12	1 1/4 - 11 1/2

## 2609 MJ - FP - FP Tee

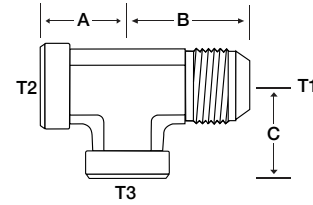

Part Number	T1	T2 / T3
	MJIC	FNPT
2609-040202	7/16 - 20	1/8 - 27
2609-040404	7/16 - 20	1/4 - 18
2609-060404	9/16 - 18	1/4 - 18
2609-080606	3/4 - 16	3/8 - 18
2609-080808	3/4 - 16	1/2 - 14
2609-121212	1 1/16 - 12	3/4 - 14
2609-161616	1 5/16 - 12	1 - 11 1/2

## 2610 MJ - MP - FP Tee

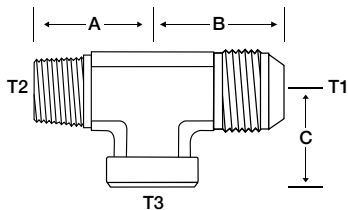

Part Number	T2 / T3	T1
	MNPT / FNPT	MJIC
2610-040404	1/4 - 18	7/16 - 20
2610-060606	3/8 - 18	9/16 - 18
2610-080808	1/2 - 14	3/4 - 16
2610-121212	3/4 - 14	1 1/16 - 12
2610-161616	1 - 11 1/2	1 5/16 - 12

BECAUSE WE CONTINUALLY EXAMINE WAYS TO IMPROVE OUR PRODUCTS, WE RESERVE THE RIGHT TO ALTER SPECIFICATIONS WITHOUT NOTICE.

## 2613 MP - FP - MJ Tee

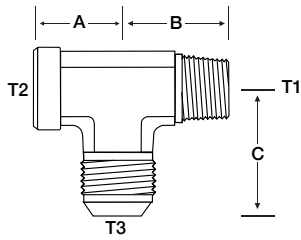

Part Number	T1 / T2	T3
	MNPT / FNPT	MJIC
2613-020204	1/8 - 27	7/16 - 20
2613-040406	1/4 - 18	9/16 - 18
2613-060606	3/8 - 18	9/16 - 18
2613-060608	3/8 - 18	3/4 - 16
2613-121212	3/4 - 14	1 1/16 - 12
2613-161616	1 - 11 1/2	1 5/16 - 12

## 2650 MJ - MJ - MJ - MJ Cross

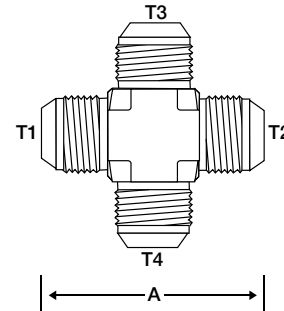

Part Number	T1 / T2	T3 / T4
	MJIC	MJIC
2650-02020202	5/16 - 24	5/16 - 24
2650-04040404	7/16 - 20	7/16 - 20
2650-05050505	1/2 - 20	1/2 - 20
2650-06060606	9/16 - 18	9/16 - 18
2650-06080608	9/16 - 18	3/4 - 16
2650-08080808	3/4 - 16	3/4 - 16
2650-10101010	7/8 - 14	7/8 - 14
2650-12121212	1 1/16 - 12	1 1/16 - 12
2650-14141414	1 3/16 - 12	1 3/16 - 12
2650-16161616	1 5/16 - 12	1 5/16 - 12
2650-20202020	1 5/8 - 12	1 5/8 - 12
2650-24242424	1 7/8 - 12	1 7/8 - 12

## 2700LN MJ - MJ Bulkhead

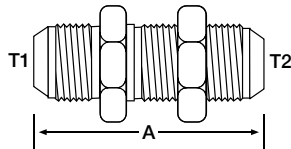

Part Number	T1	T2
	MJIC	MJIC
2700LN-0404	7/16 - 20	7/16 - 20
2700LN-0406	7/16 - 20	9/16 - 18
2700LN-0505	1/2 - 20	1/2 - 20
2700LN-0604	9/16 - 18	7/16 - 20
2700LN-0606	9/16 - 18	9/16 - 18
2700LN-0808	3/4 - 16	3/4 - 16
2700LN-1010	7/8 - 14	7/8 - 14
2700LN-1212	1 1/16 - 12	1 1/16 - 12
2700LN-1414	1 3/16 - 12	1 3/16 - 12
2700LN-1616	1 5/16 - 12	1 5/16 - 12
2700LN-2020	1 5/8 - 12	1 5/8 - 12
2700LN-2424	1 7/8 - 12	1 7/8 - 12
2700LN-3232	2 1/2 - 12	2 1/2 - 12

BECAUSE WE CONTINUALLY EXAMINE WAYS TO IMPROVE OUR PRODUCTS, WE RESERVE THE RIGHT TO ALTER SPECIFICATIONS WITHOUT NOTICE.

# JIC and Pipe

## 2701LN MJ - MJ Bulkhead 90°

SAE# 070701

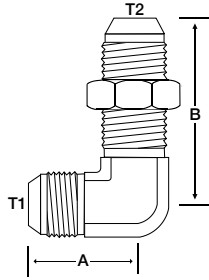

## 2702LN MJ - MJ Bulkhead 45°

SAE# 070801

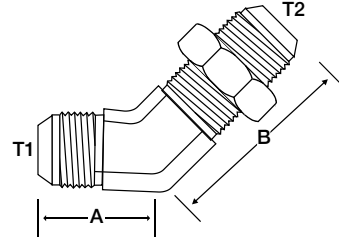

Part Number	T1	T2
	MJIC	MJIC
2701LN-0303	3/8 - 24	3/8 - 24
2701LN-0404	7/16 - 20	7/16 - 20
2701LN-0505	1/2 - 20	1/2 - 20
2701LN-0606	9/16 - 18	9/16 - 18
2701LN-0808	3/4 - 16	3/4 - 16
2701LN-1010	7/8 - 14	7/8 - 14
2701LN-1212	1 1/16 - 12	1 1/16 - 12
2701LN-1616	1 5/16 - 12	1 5/16 - 12
2701LN-2020	1 5/8 - 12	1 5/8 - 12
2701LN-2424	1 7/8 - 12	1 7/8 - 12

Part Number	T1	T1
	MJIC	MJIC
2702LN-0303	3/8 - 24	3/8 - 24
2702LN-0404	7/16 - 20	7/16 - 20
2702LN-0505	1/2 - 20	1/2 - 20
2702LN-0606	9/16 - 18	9/16 - 18
2702LN-0808	3/4 - 16	3/4 - 16
2702LN-1010	7/8 - 14	7/8 - 14
2702LN-1212	1 1/16 - 12	1 1/16 - 12
2702LN-1616	1 5/16 - 12	1 5/16 - 12
2702LN-2020	1 5/8 - 12	1 5/8 - 12
2702LN-2424	1 7/8 - 12	1 7/8 - 12

## 2703LN MJ - MJ - MJ Bulkhead Tee

SAE# 070959

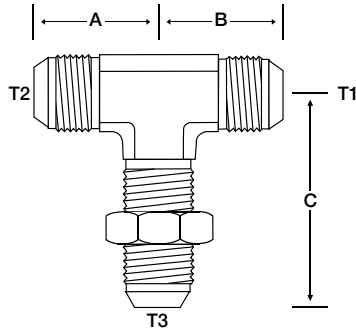

Part Number	T1 / T2	T3
	MJIC	MJIC
2703LN-030303	3/8 - 24	3/8 - 24
2703LN-040404	7/16 - 20	7/16 - 20
2703LN-040406	7/16 - 20	9/16 - 18
2703LN-050505	1/2 - 20	1/2 - 20
2703LN-060606	9/16 - 18	9/16 - 18
2703LN-080808	3/4 - 16	3/4 - 16
2703LN-101010	7/8 - 14	7/8 - 14
2703LN-121212	1 1/16 - 12	1 1/16 - 12
2703LN-161616	1 5/16 - 12	1 5/16 - 12
2703LN-202020	1 5/8 - 12	1 5/8 - 12
2703LN-242424	1 7/8 - 12	1 7/8 - 12

BECAUSE WE CONTINUALLY EXAMINE WAYS TO IMPROVE OUR PRODUCTS, WE RESERVE THE RIGHT TO ALTER SPECIFICATIONS WITHOUT NOTICE.



## 2704LN MJ - MJ - MJ Bulkhead Tee

SAE# 070958

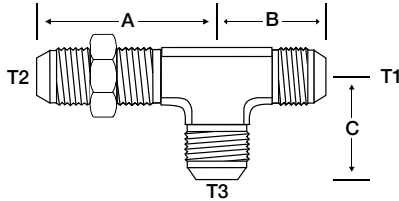

Part Number	T1 / T2 / T3
	MJIC
2704LN-030303	3/8 - 24
2704LN-040404	7/16 - 20
2704LN-050505	1/2 - 20
2704LN-060606	9/16 - 18
2704LN-080808	3/4 - 16
2704LN-101010	7/8 - 14
2704LN-121212	1 1/16 - 12
2704LN-161616	1 5/16 - 12
2704LN-202020	1 5/8 - 12
2704LN-242424	1 7/8 - 12

## 2705LN FP - MJ Bulkhead

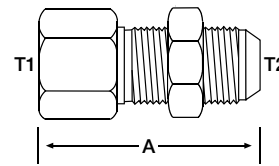

Part Number	T1	T2
	FNPT	MJIC
2705LN-0204	1/8 - 27	7/16 - 20
2705LN-0404	1/4 - 18	7/16 - 20
2705LN-0406	1/4 - 18	9/16 - 18
2705LN-0606	3/8 - 18	9/16 - 18
2705LN-0608	3/8 - 18	3/4 - 16
2705LN-0808	1/2 - 14	3/4 - 16
2705LN-0810	1/2 - 14	7/8 - 14
2705LN-1212	3/4 - 14	1 1/16 - 12
2705LN-1616	1 - 11 1/2	1 5/16 - 12
2705LN-2020	1 1/4 - 11 1/2	1 5/8 - 12
2705LN-2424	1 1/2 - 11 1/2	1 7/8 - 12

## 2706LN MP - MJ Bulkhead

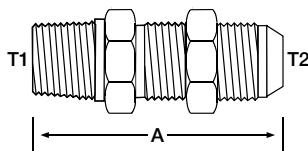

Part Number	T1	T2
	MNPT	MJIC
2706LN-0204	1/8 - 27	7/16 - 20
2706LN-0404	1/4 - 18	7/16 - 20
2706LN-0406	1/4 - 18	9/16 - 18
2706LN-0606	3/8 - 18	9/16 - 18
2706LN-0608	3/8 - 18	3/4 - 16
2706LN-0808	1/2 - 14	3/4 - 16
2706LN-0810	1/2 - 14	7/8 - 14
2706LN-1212	3/4 - 14	1 1/16 - 12
2706LN-1616	1 - 11 1/2	1 5/16 - 12
2706LN-2020	1 1/4 - 11 1/2	1 5/8 - 12
2706LN-2424	1 1/2 - 11 1/2	1 7/8 - 12

## 3474 MAORB - MORB

SAE#

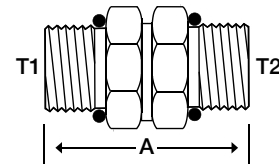

Part Number	T1	T2
	MAORB	MAORB
3474-0404	7/16 - 20	7/16 - 20
3474-0604	9/16 - 18	7/16 - 20
3474-0606	9/16 - 18	9/16 - 18
3474-0806	3/4 - 16	9/16 - 18
3474-0808	3/4 - 16	3/4 - 16
3474-1010	7/8 - 14	7/8 - 14
3474-1212	1 1/16 - 12	1 1/16 - 12
3474-1612	1 5/16 - 12	1 1/16 - 12
3474-1616	1 5/16 - 12	1 5/16 - 12
3474-2020	1 5/8 - 12	1 5/8 - 12
3474-2424	1 7/8 - 12	1 7/8 - 12

BECAUSE WE CONTINUALLY EXAMINE WAYS TO IMPROVE OUR PRODUCTS, WE RESERVE THE RIGHT TO ALTER SPECIFICATIONS WITHOUT NOTICE.

# JIC and Pipe

## 4404 HB - MP Straight

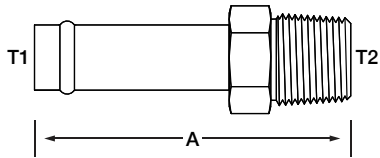

Part Number	T1	T2
	HB	MNPT
4404-0402	1/4	1/8 - 27
4404-0404	1/4	1/4 - 18
4404-0602	3/8	1/8 - 27
4404-0604	3/8	1/4 - 18
4404-0606	3/8	3/8 - 18
4404-0804	1/2	1/4 - 18
4404-0806	1/2	3/8 - 18
4404-0808	1/2	1/2 - 14
4404-0812	1/2	3/4 - 14
4404-1006	5/8	3/8 - 18
4404-1008	5/8	1/2 - 14
4404-1208	3/4	1/2 - 14
4404-1212	3/4	3/4 - 14
4404-1612	1	3/4 - 14
4404-1616	1	1 - 11 1/2
4404-2016	1 1/4	1 - 11 1/2
4404-2020	1 1/4	1 1/4 - 11 1/2
4404-2024	1 1/4	1 1/2 - 11 1/2
4404-2420	1 1/2	1 1/4 - 11 1/2
4404-2424	1 1/2	1 1/2 - 11 1/2

## 4501 HB - MP 90°

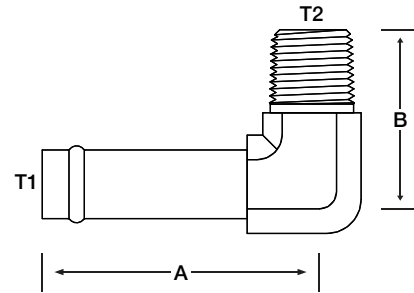

Part Number	T1	T2
	HB	MNPT
4501-0402	1/4	1/8 - 27
4501-0404	1/4	1/4 - 18
4501-0604	3/8	1/4 - 18
4501-0606	3/8	3/8 - 18
4501-0806	1/2	3/8 - 18
4501-0808	1/2	1/2 - 14
4501-0812	1/2	3/4 - 14
4501-1008	5/8	1/2 - 14
4501-1012	5/8	3/4 - 14
4501-1208	3/4	1/2 - 14
4501-1212	3/4	3/4 - 14
4501-1216	3/4	1 - 11 1/2
4501-1612	1	3/4 - 14
4501-1616	1	1 - 11 1/2

BECAUSE WE CONTINUALLY EXAMINE WAYS TO IMPROVE OUR PRODUCTS, WE RESERVE THE RIGHT TO ALTER SPECIFICATIONS WITHOUT NOTICE.

## 4503 HB - MP 45°

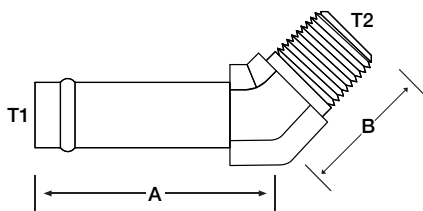

Part Number	T1	T2
	HB	MNPT
4503-0402	1/4	1/8 - 27
4503-0404	1/4	1/4 - 18
4503-0604	3/8	1/4 - 18
4503-0806	1/2	3/8 - 18
4503-0808	1/2	1/2 - 14
4503-1008	5/8	1/2 - 14
4503-1212	3/4	3/4 - 14
4503-1616	1	1 - 11 1/2
4503-2020	1 1/4	1 1/4 - 11 1/2
4503-2424	1 1/2	1 1/2 - 11 1/2

## 4601 HB - MAORB 90°

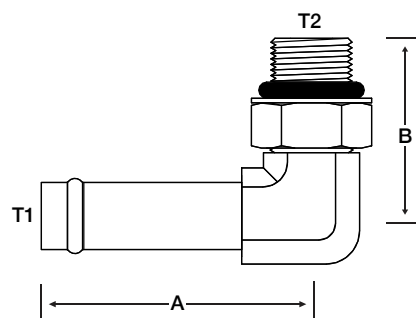

Part Number	T1	T2
	HB	MORB
4601-0404	1/4	7/16 - 20
4601-0406	1/4	9/16 - 18
4601-0604	3/8	7/16 - 20
4601-0606	3/8	9/16 - 18
4601-0608	3/8	3/4 - 16
4601-0806	1/2	9/16 - 18
4601-0808	1/2	3/4 - 16
4601-1008	5/8	3/4 - 16
4601-1010	5/8	7/8 - 14
4601-1012	5/8	1 1/16 - 12
4601-1208	3/4	3/4 - 16
4601-1210	3/4	7/8 - 14
4601-1212	3/4	1 1/16 - 12
4601-1216	3/4	1 5/16 - 12
4601-1610	1	7/8 - 14
4601-1612	1	1 1/16 - 12
4601-1616	1	1 5/16 - 12
4601-1620	1	1 5/8 - 12
4601-2016	1 1/4	1 5/16 - 12
4601-2020	1 1/4	1 5/8 - 12
4601-2424	1 1/2	1 7/8 - 12

BECAUSE WE CONTINUALLY EXAMINE WAYS TO IMPROVE OUR PRODUCTS, WE RESERVE THE RIGHT TO ALTER SPECIFICATIONS WITHOUT NOTICE.

# JIC and Pipe

## 4603 HB - MAORB 45°

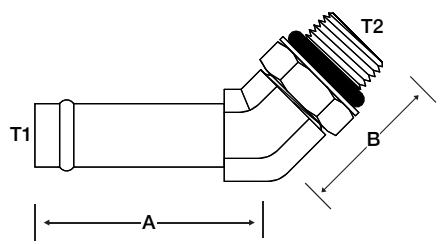

Part Number	T1	T2
	HB	MORB
4603-0404	1/4	7/16 - 20
4603-0606	3/8	9/16 - 18
4603-0808	1/2	3/4 - 16
4603-1010	5/8	7/8 - 14
4603-1012	5/8	1 1/16 - 12
4603-1208	3/4	3/4 - 16
4603-1210	3/4	7/8 - 14
4603-1212	3/4	1 1/16 - 12
4603-1612	1	1 1/16 - 12
4603-1616	1	1 5/16 - 12
4603-2016	1 1/4	1 5/16 - 12
4603-2020	1 1/4	1 5/8 - 12
4603-2420	1 1/2	1 5/8 - 12
4603-2424	1 1/2	1 7/8 - 12

## 4604 HB - MORB

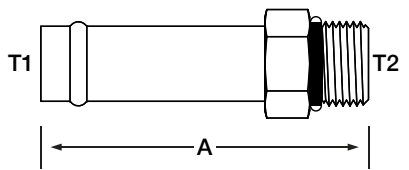

Part Number	T1	T2
	HB	MORB
4604-0404	1/4	7/16 - 20
4604-0604	3/8	7/16 - 20
4604-0606	3/8	9/16 - 18
4604-0806	1/2	9/16 - 18
4604-0808	1/2	3/4 - 16
4604-1008	5/8	3/4 - 16
4604-1010	5/8	7/8 - 14
4604-1208	3/4	3/4 - 16
4604-1210	3/4	7/8 - 14
4604-1212	3/4	1 1/16 - 12
4604-1216	3/4	1 5/16 - 12
4604-1612	1	1 1/16 - 12
4604-1616	1	1 5/16 - 12
4604-1620	1	1 5/8 - 12
4604-2016	1 1/4	1 5/16 - 12
4604-2020	1 1/4	1 5/8 - 12
4604-2024	1 1/4	1 7/8 - 12
4604-2424	1 1/2	1 7/8 - 12

BECAUSE WE CONTINUALLY EXAMINE WAYS TO IMPROVE OUR PRODUCTS, WE RESERVE THE RIGHT TO ALTER SPECIFICATIONS WITHOUT NOTICE.

## 5000 FP - FP Straight

SAE# 140138

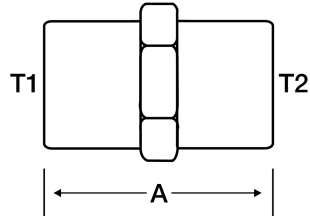

Part Number	T1	T2
	FNPT	FNPT
5000-0202	1/8 - 27	1/8 - 27
5000-0402	1/4 - 18	1/8 - 27
5000-0404	1/4 - 18	1/4 - 18
5000-0604	3/8 - 18	1/4 - 18
5000-0606	3/8 - 18	3/8 - 18
5000-0804	1/2 - 14	1/4 - 18
5000-0806	1/2 - 14	3/8 - 18
5000-0808	1/2 - 14	1/2 - 14
5000-1206	3/4 - 14	3/8 - 18
5000-1208	3/4 - 14	1/2 - 14
5000-1212	3/4 - 14	3/4 - 14
5000-1612	1 - 11 1/2	3/4 - 14
5000-1616	1 - 11 1/2	1 - 11 1/2
5000-2020	1 1/4 - 11 1/2	1 1/4 - 11 1/2
5000-2424	1 1/2 - 11 1/2	1 1/2 - 11 1/2
5000-3232	2 - 11 1/2	2 - 11 1/2

## 5404 MP - MP Straight

SAE# 140137

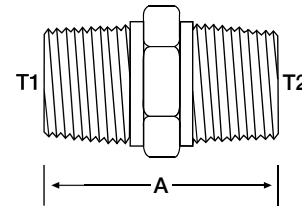

Part Number	T1	T2
	MNPT	MNPT
5404-0202	1/8 - 27	1/8 - 27
5404-0402	1/4 - 18	1/8 - 27
5404-0404	1/4 - 18	1/4 - 18
5404-0602	3/8 - 18	1/8 - 27
5404-0604	3/8 - 18	1/4 - 18
5404-0606	3/8 - 18	3/8 - 18
5404-0804	1/2 - 14	1/4 - 18
5404-0806	1/2 - 14	3/8 - 18
5404-0808	1/2 - 14	1/2 - 14
5404-1206	3/4 - 14	3/8 - 18
5404-1208	3/4 - 14	1/2 - 14
5404-1212	3/4 - 14	3/4 - 14
5404-1606	1 - 11 1/2	3/8 - 18
5404-1608	1 - 11 1/2	1/2 - 14
5404-1612	1 - 11 1/2	3/4 - 14
5404-1616	1 - 11 1/2	1 - 11 1/2
5404-2012	1 1/4 - 11 1/2	3/4 - 14
5404-2016	1 1/4 - 11 1/2	1 - 11 1/2
5404-2020	1 1/4 - 11 1/2	1 1/4 - 11 1/2
5404-2412	1 1/2 - 11 1/2	3/4 - 14
5404-2416	1 1/2 - 11 1/2	1 - 11 1/2
5404-2420	1 1/2 - 11 1/2	1 1/4 - 11 1/2
5404-2424	1 1/2 - 11 1/2	1 1/2 - 11 1/2
5404-3220	2 - 11 1/2	1 1/4 - 11 1/2
5404-3224	2 - 11 1/2	1 1/2 - 11 1/2
5404-3232	2 - 11 1/2	2 - 11 1/2

# JIC and Pipe

## 5405 MP - FP Straight

SAE# 140139

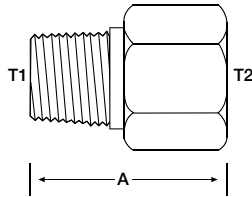

## 5406 MP - FP Reducing Bushing

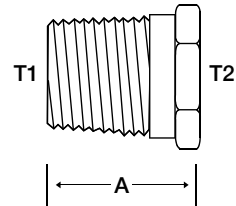

Part Number	T1	T2
	MNPT	FNPT
5405-0202	1/8 - 27	1/8 - 27
5405-0204	1/8 - 27	1/4 - 18
5405-0208	1/8 - 27	1/2 - 14
5405-0404	1/4 - 18	1/4 - 18
5405-0406	1/4 - 18	3/8 - 18
5405-0408	1/4 - 18	1/2 - 14
5405-0604	3/8 - 18	1/4 - 18
5405-0606	3/8 - 18	3/8 - 18
5405-0608	3/8 - 18	1/2 - 14
5405-0612	3/8 - 18	3/4 - 14
5405-0806	1/2 - 14	3/8 - 18
5405-0808	1/2 - 14	1/2 - 14
5405-0812	1/2 - 14	3/4 - 14
5405-0816	1/2 - 14	1 - 11 1/2
5405-1212	3/4 - 14	3/4 - 14
5405-1216	3/4 - 14	1 - 11 1/2
5405-1616	1 - 11 1/2	1 - 11 1/2
5405-1620	1 - 11 1/2	1 1/4 - 11 1/2
5405-2016	1 1/4 - 11 1/2	1 - 11 1/2
5405-2024	1 1/4 - 11 1/2	1 1/2 - 11 1/2
5405-2432	1 1/2 - 11 1/2	2 - 11 1/2

Part Number	T1	T2
	MNPT	FNPT
5406-0402	1/4 - 18	1/8 - 27
5406-0602	3/8 - 18	1/8 - 27
5406-0604	3/8 - 18	1/4 - 18
5406-0802	1/2 - 14	1/8 - 27
5406-0804	1/2 - 14	1/4 - 18
5406-0806	1/2 - 14	3/8 - 18
5406-1204	3/4 - 14	1/4 - 18
5406-1206	3/4 - 14	3/8 - 18
5406-1208	3/4 - 14	1/2 - 14
5406-1604	1 - 11 1/2	1/4 - 18
5406-1606	1 - 11 1/2	3/8 - 18
5406-1608	1 - 11 1/2	1/2 - 14
5406-1612	1 - 11 1/2	3/4 - 14
5406-2004	1 1/4 - 11 1/2	1/4 - 18
5406-2006	1 1/4 - 11 1/2	3/8 - 18
5406-2008	1 1/4 - 11 1/2	1/2 - 14
5406-2012	1 1/4 - 11 1/2	3/4 - 14
5406-2016	1 1/4 - 11 1/2	1 - 11 1/2
5406-2406	1 1/2 - 11 1/2	3/8 - 18
5406-2412	1 1/2 - 11 1/2	3/4 - 14
5406-2416	1 1/2 - 11 1/2	1 - 11 1/2
5406-2420	1 1/2 - 11 1/2	1 1/4 - 11 1/2
5406-3220	2 - 11 1/2	1 1/4 - 11 1/2
5406-3224	2 - 11 1/2	1 1/2 - 11 1/2

BECAUSE WE CONTINUALLY EXAMINE WAYS TO IMPROVE OUR PRODUCTS, WE RESERVE THE RIGHT TO ALTER SPECIFICATIONS WITHOUT NOTICE.

## 5406C FP Pipe Cap

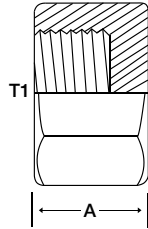

Part Number	T1
	FNPT
5406C-02	1/8 - 27
5406C-04	1/4 - 18
5406C-06	3/8 - 18
5406C-08	1/2 - 14
5406C-12	3/4 - 14
5406C-16	1 - 11 1/2
5406C-20	1 1/4 - 11 1/2
5406C-24	1 1/2 - 11 1/2
5406C-32	2 - 11 1/2

## 5406HP MP Hollow Hex Plug

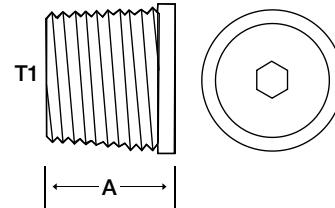

Part Number	T1
	MNPT
5406HP-02	1/8 - 27
5406HP-04	1/4 - 18
5406HP-06	3/8 - 18
5406HP-08	1/2 - 14
5406HP-12	3/4 - 14
5406HP-16	1 - 11 1/2
5406HP-20	1 1/4 - 11 1/2
5406HP-24	1 1/2 - 11 1/2
5406HP-32	2 - 11 1/2

## 5406 MP Pipe Plug

SAE# 130109E

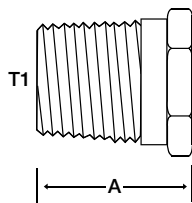

Part Number	T1
	MNPT
5406P-02	1/8 - 27
5406P-04	1/4 - 18
5406P-06	3/8 - 18
5406P-08	1/2 - 14
5406P-12	3/4 - 14
5406P-16	1 - 11 1/2
5406P-20	1 1/4 - 11 1/2
5406P-24	1 1/2 - 11 1/2
5406P-32	2 - 11 1/2

## 5406SHP MP Square Head Plug

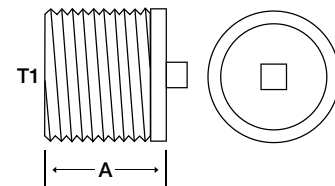

Part Number	T1
	MNPT
5406SHP-02	1/8 - 27
5406SHP-04	1/4 - 18
5406SHP-06	3/8 - 18
5406SHP-08	1/2 - 14
5406SHP-12	3/4 - 14
5406SHP-16	1 - 11 1/2

BECAUSE WE CONTINUALLY EXAMINE WAYS TO IMPROVE OUR PRODUCTS, WE RESERVE THE RIGHT TO ALTER SPECIFICATIONS WITHOUT NOTICE.

# JIC and Pipe

## 5500 MP - MP 90°

SAE# 140237

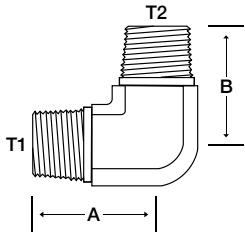

Part Number	T1	T2
	MNPT	MNPT
5500-0202	1/8 - 27	1/8 - 27
5500-0402	1/4 - 18	1/8 - 27
5500-0404	1/4 - 18	1/4 - 18
5500-0604	3/8 - 18	1/4 - 18
5500-0606	3/8 - 18	3/8 - 18
5500-0804	1/2 - 14	1/4 - 18
5500-0806	1/2 - 14	3/8 - 18
5500-0808	1/2 - 14	1/2 - 14
5500-1208	3/4 - 14	1/2 - 14
5500-1212	3/4 - 14	3/4 - 14
5500-1608	1 - 11 1/2	1/2 - 14
5500-1612	1 - 11 1/2	3/4 - 14
5500-1616	1 - 11 1/2	1 - 11 1/2
5500-2020	1 1/4 - 11 1/2	1 1/4 - 11 1/2
5500-2424	1 1/2 - 11 1/2	1 1/2 - 11 1/2
5500-3232	2 - 11 1/2	2 - 11 1/2

## 5501 MP - MP 45°

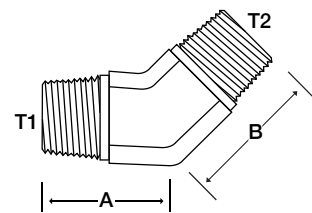

Part Number	T1	T2
	MNPT	MNPT
5501-0404	1/4 - 18	1/4 - 18
5501-0606	3/8 - 18	3/8 - 18
5501-0808	1/2 - 14	1/2 - 14
5501-1212	3/4 - 14	3/4 - 14
5501-1616	1 - 11 1/2	1 - 11 1/2
5501-2020	1 1/4 - 11 1/2	1 1/4 - 11 1/2
5501-2424	1 1/2 - 11 1/2	1 1/2 - 11 1/2

## 5502 MP - FP 90°

SAE# 140239

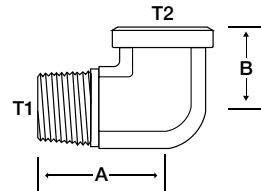

Part Number	T1	T2
	MNPT	FNPT
5502-0202	1/8 - 27	1/8 - 27
5502-0204	1/8 - 27	1/4 - 18
5502-0402	1/4 - 18	1/8 - 27
5502-0404	1/4 - 18	1/4 - 18
5502-0406	1/4 - 18	3/8 - 18
5502-0604	3/8 - 18	1/4 - 18
5502-0606	3/8 - 18	3/8 - 18
5502-0608	3/8 - 18	1/2 - 14
5502-0804	1/2 - 14	1/4 - 18
5502-0806	1/2 - 14	3/8 - 18
5502-0808	1/2 - 14	1/2 - 14
5502-0812	1/2 - 14	3/4 - 14
5502-1208	3/4 - 14	1/2 - 14
5502-1212	3/4 - 14	3/4 - 14
5502-1612	1 - 11 1/2	3/4 - 14
5502-1616	1 - 11 1/2	1 - 11 1/2
5502-2016	1 1/4 - 11 1/2	1 - 11 1/2
5502-2020	1 1/4 - 11 1/2	1 1/4 - 11 1/2
5502-2424	1 1/2 - 11 1/2	1 1/2 - 11 1/2
5502-3232	2 - 11 1/2	2 - 11 1/2

BECAUSE WE CONTINUALLY EXAMINE WAYS TO IMPROVE OUR PRODUCTS, WE RESERVE THE RIGHT TO ALTER SPECIFICATIONS WITHOUT NOTICE.



## 5503 MP - FP 45°

SAE# 140339

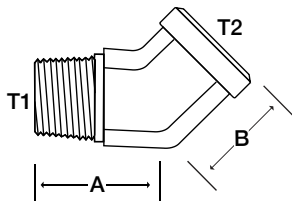

Part Number	T1	T2
	MNPT	FNPT
5503-0202	1/8 - 27	1/8 - 27
5503-0404	1/4 - 18	1/4 - 18
5503-0606	3/8 - 18	3/8 - 18
5503-0808	1/2 - 14	1/2 - 14
5503-1212	3/4 - 14	3/4 - 14
5503-1616	1 - 11 1/2	1 - 11 1/2
5503-2020	1 1/4 - 11 1/2	1 1/4 - 11 1/2
5503-2424	1 1/2 - 11 1/2	1 1/2 - 11 1/2

## 5504 FP - FP 90°

SAE# 140238

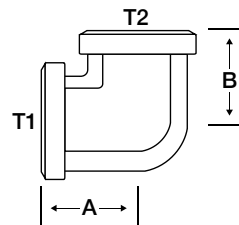

Part Number	T1	T2
	FNPT	FNPT
5504-0202	1/8 - 27	1/8 - 27
5504-0402	1/4 - 18	1/8 - 27
5504-0404	1/4 - 18	1/4 - 18
5504-0604	3/8 - 18	1/4 - 18
5504-0606	3/8 - 18	3/8 - 18
5504-0804	1/2 - 14	1/4 - 18
5504-0806	1/2 - 14	3/8 - 18
5504-0808	1/2 - 14	1/2 - 14
5504-1208	3/4 - 14	1/2 - 14
5504-1212	3/4 - 14	3/4 - 14
5504-1612	1 - 11 1/2	3/4 - 14
5504-1616	1 - 11 1/2	1 - 11 1/2
5504-2020	1 1/4 - 11 1/2	1 1/4 - 11 1/2
5504-2424	1 1/2 - 11 1/2	1 1/2 - 11 1/2
5504-3232	2 - 11 1/2	2 - 11 1/2

## 5505 FP - FP 45°

SAE# 140338

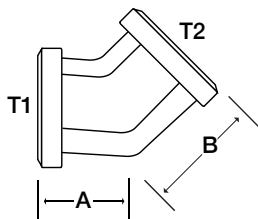

Part Number	T1	T2
	FNPT	FNPT
5505-0202	1/8 - 27	1/8 - 27
5505-0404	1/4 - 18	1/4 - 18
5505-0606	3/8 - 18	3/8 - 18
5505-0808	1/2 - 14	1/2 - 14
5505-1212	3/4 - 14	3/4 - 14
5505-1616	1 - 11 1/2	1 - 11 1/2

## 5600 MP - MP - MP Tee

SAE# 140437

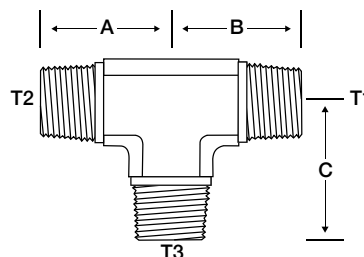

Part Number	T1 / T2 / T3
	MNPT
5600-020202	1/8 - 27
5600-040404	1/4 - 18
5600-060606	3/8 - 18
5600-080808	1/2 - 14
5600-121212	3/4 - 14
5600-161616	1 - 11 1/2

BECAUSE WE CONTINUALLY EXAMINE WAYS TO IMPROVE OUR PRODUCTS, WE RESERVE THE RIGHT TO ALTER SPECIFICATIONS WITHOUT NOTICE.

# JIC and Pipe

**5601 MP - MP - FP Tee**  
SAE# 140427

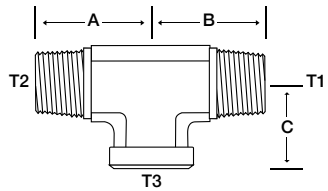

Part Number	T1 / T2	T3
	MNPT	FNPT
5601-020202	1/8 - 27	1/8 - 27
5601-040404	1/4 - 18	1/4 - 18
5601-060606	3/8 - 18	3/8 - 18
5601-080808	1/2 - 14	1/2 - 14
5601-121212	3/4 - 14	3/4 - 14
5601-161616	1 - 11 1/2	1 - 11 1/2
5601-202020	1 1/4 - 11 1/2	1 1/4 - 11 1/2
5601-242424	1 1/2 - 11 1/2	1 1/2 - 11 1/2

**5602 MP - FP - FP Tee**  
SAE# 140424

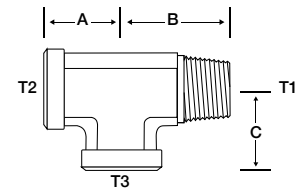

Part Number	T1	T2 / T3
	MNPT	FNPT
5602-020202	1/8 - 27	1/8 - 27
5602-040404	1/4 - 18	1/4 - 18
5602-060606	3/8 - 18	3/8 - 18
5602-080808	1/2 - 14	1/2 - 14
5602-121212	3/4 - 14	3/4 - 14
5602-161616	1 - 11 1/2	1 - 11 1/2
5602-202020	1 1/4 - 11 1/2	1 1/4 - 11 1/2
5602-242424	1 1/2 - 11 1/2	1 1/2 - 11 1/2
5602-323232	2 - 11 1/2	2 - 11 1/2

**5603 MP - FP - MP Tee**  
SAE# 140426

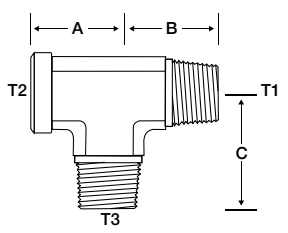

Part Number	T1 / T3	T2
	MNPT	FNPT
5603-020202	1/8 - 27	1/8 - 27
5603-040404	1/4 - 18	1/4 - 18
5603-060606	3/8 - 18	3/8 - 18
5603-080808	1/2 - 14	1/2 - 14
5603-121212	3/4 - 14	3/4 - 14
5603-161616	1 - 11 1/2	1 - 11 1/2
5603-202020	1 1/4 - 11 1/2	1 1/4 - 11 1/2
5603-242424	1 1/2 - 11 1/2	1 1/2 - 11 1/2

**5604 FP - FP - MP Tee**  
SAE# 140425

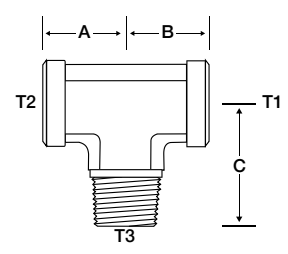

Part Number	T1 / T2	T3
	FNPT	MNPT
5604-020202	1/8 - 27	1/8 - 27
5604-040404	1/4 - 18	1/4 - 18
5604-060606	3/8 - 18	3/8 - 18
5604-080808	1/2 - 14	1/2 - 14
5604-121212	3/4 - 14	3/4 - 14
5604-161616	1 - 11 1/2	1 - 11 1/2
5604-202020	1 1/4 - 11 1/2	1 1/4 - 11 1/2
5604-242424	1 1/2 - 11 1/2	1 1/2 - 11 1/2

BECAUSE WE CONTINUALLY EXAMINE WAYS TO IMPROVE OUR PRODUCTS, WE RESERVE THE RIGHT TO ALTER SPECIFICATIONS WITHOUT NOTICE.

## 5605 FP - FP - FP Tee

SAE# 140438

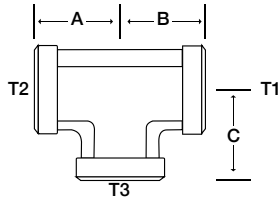

Part Number	T1 / T2 / T3
	FNPT
5605-020202	1/8 - 27
5605-040404	1/4 - 18
5605-060606	3/8 - 18
5605-080808	1/2 - 14
5605-121212	3/4 - 14
5605-161616	1 - 11½
5605-202020	1¼ - 11½
5605-242424	1½ - 11½
5605-323232	2 - 11½

## 5652 FP - FP - FP - FP Cross

SAE# 140538

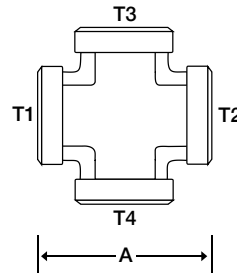

Part Number	T1 / T2 / T3 / T4
	FNPT
5652-02020202	1/8 - 27
5652-04040404	1/4 - 18
5652-06060606	3/8 - 18
5652-08080808	1/2 - 14
5652-12121212	3/4 - 14
5652-16161616	1 - 11½
5652-20202020	1¼ - 11½
5652-24242424	1½ - 11½
5652-32323232	2 - 11½

## 6400 MJ - MORB Straight

SAE# 070120

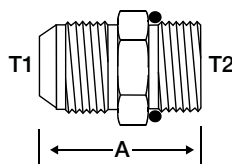

Part Number	T1	T2
	MJIC	MORB
6400-0202	5/16 - 24	5/16 - 24
6400-0303	3/8 - 24	3/8 - 24
6400-0402	7/16 - 20	5/16 - 24
6400-0403	7/16 - 20	3/8 - 24
6400-0404	7/16 - 20	7/16 - 20
6400-0405	7/16 - 20	1/2 - 20
6400-0406	7/16 - 20	9/16 - 18
6400-0408	7/16 - 20	3/4 - 16
6400-0410	7/16 - 20	7/8 - 14
6400-0412	7/16 - 20	1 1/16 - 12
6400-0504	1/2 - 20	7/16 - 20
6400-0505	1/2 - 20	1/2 - 20
6400-0506	1/2 - 20	9/16 - 18
6400-0604	9/16 - 18	7/16 - 20
6400-0605	9/16 - 18	1/2 - 20
6400-0606	9/16 - 18	9/16 - 18
6400-0608	9/16 - 18	3/4 - 16
6400-0610	9/16 - 18	7/8 - 14
6400-0612	9/16 - 18	1 1/16 - 12
6400-0804	3/4 - 16	7/16 - 24
6400-0806	3/4 - 16	9/16 - 18
6400-0808	3/4 - 16	3/4 - 16
6400-0810	3/4 - 16	7/8 - 14
6400-0812	3/4 - 16	1 1/16 - 12
6400-0816	3/4 - 16	1 5/16 - 12
6400-0820	3/4 - 16	1 5/8 - 12
6400-1004	7/8 - 14	7/16 - 20
6400-1006	7/8 - 14	9/16 - 18
6400-1008	7/8 - 14	3/4 - 16
6400-1010	7/8 - 14	7/8 - 14
6400-1012	7/8 - 14	1 1/16 - 12
6400-1016	7/8 - 14	1 5/16 - 12
6400-1206	1 1/16 - 12	9/16 - 18
6400-1208	1 1/16 - 12	3/4 - 16
6400-1210	1 1/16 - 12	7/8 - 14
6400-1212	1 1/16 - 12	1 1/16 - 12

Part Number	T1	T2
	MJIC	MORB
6400-1214	1 1/16 - 12	1 3/16 - 12
6400-1216	1 1/16 - 12	1 5/16 - 12
6400-1216	1 1/16 - 12	1 5/16 - 12
6400-1220	1 1/16 - 12	1 5/8 - 12
6400-1412	1 3/16 - 12	1 1/16 - 12
6400-1414	1 3/16 - 12	1 3/16 - 12
6400-1416	1 3/16 - 12	1 5/16 - 12
6400-1608	1 5/16 - 12	3/4 - 16
6400-1610	1 5/16 - 12	7/8 - 14
6400-1612	1 5/16 - 12	1 1/16 - 12
6400-1614	1 5/16 - 12	1 3/16 - 12
6400-1616	1 5/16 - 12	1 5/16 - 12
6400-1620	1 5/16 - 12	1 5/8 - 12
6400-1624	1 5/16 - 12	1 7/8 - 12
6400-2016	1 5/8 - 12	1 5/16 - 12
6400-2020	1 5/8 - 12	1 5/8 - 12
6400-2024	1 5/8 - 12	1 7/8 - 12
6400-2416	1 7/8 - 12	1 5/16 - 12
6400-2420	1 7/8 - 12	1 5/8 - 12
6400-2424	1 7/8 - 12	1 7/8 - 12
6400-2432	1 7/8 - 12	2 1/2 - 12
6400-3220	2 1/2 - 12	1 5/8 - 12
6400-3224	2 1/2 - 12	1 7/8 - 12
6400-3232	2 1/2 - 12	2 1/2 - 12

BECAUSE WE CONTINUALLY EXAMINE WAYS TO IMPROVE OUR PRODUCTS, WE RESERVE THE RIGHT TO ALTER SPECIFICATIONS WITHOUT NOTICE.

## 6400L MJ - MORB Long

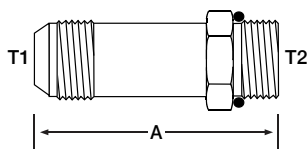

Part Number	T1	T2
	MJIC	MORB
6400L-0404	7/16 - 20	7/16 - 20
6400L-0505	1/2 - 20	1/2 - 20
6400L-0606	9/16 - 18	9/16 - 18
6400L-0608	9/16 - 18	3/4 - 16
6400L-0808	3/4 - 16	3/4 - 16
6400L-1010	7/8 - 14	7/8 - 14
6400L-1212	1 1/16 - 12	1 1/16 - 12
6400L-1616	1 5/16 - 12	1 5/16 - 12
6400L-2020	1 5/8 - 12	1 5/8 - 12

## 6402 MORB - FJX

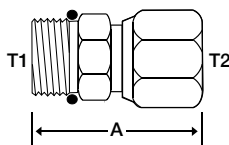

Part Number	T1	T2
	MORB	FJIC
6402-0406	7/16 - 20	9/16 - 18
6402-0606	9/16 - 18	9/16 - 18
6402-0608	9/16 - 18	3/4 - 16
6402-0808	3/4 - 16	3/4 - 16
6402-1010	7/8 - 14	7/8 - 14
6402-1212	1 1/16 - 12	1 1/16 - 12
6402-1616	1 5/16 - 12	1 5/16 - 12
6402-2020	1 5/8 - 12	1 5/8 - 12
6402-2424	1 7/8 - 12	1 7/8 - 12
6402-3232	2 1/2 - 12	2 1/2 - 12

## 6401 MORB - MP

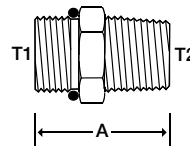

Part Number	T1	T2
	MORB	MNPT
6401-0402	7/16 - 20	1/8 - 27
6401-0404	7/16 - 20	1/4 - 18
6401-0504	1/2 - 20	1/4 - 18
6401-0604	9/16 - 18	1/4 - 18
6401-0606	9/16 - 18	3/8 - 18
6401-0608	9/16 - 18	1/2 - 14
6401-0806	3/4 - 16	3/8 - 18
6401-0808	3/4 - 16	1/2 - 14
6401-0812	3/4 - 16	3/4 - 14
6401-1004	7/8 - 14	1/4 - 18
6401-1006	7/8 - 14	3/8 - 18
6401-1008	7/8 - 14	1/2 - 14
6401-1012	7/8 - 14	3/4 - 14
6401-1206	1 1/16 - 12	3/8 - 18
6401-1208	1 1/16 - 12	1/2 - 14
6401-1212	1 1/16 - 12	3/4 - 14
6401-1612	1 5/16 - 12	3/4 - 14
6401-1616	1 5/16 - 12	1 - 11 1/2
6401-2020	1 5/8 - 12	1 1/4 - 11 1/2
6401-2424	1 7/8 - 12	1 1/2 - 11 1/2
6401-3232	2 1/2 - 12	2 - 11 1/2

## 6404 FORB - MP

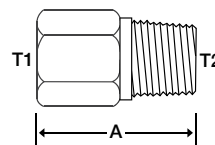

Part Number	T1	T2
	FORB	MNPT
6404-0402	7/16 - 20	1/8 - 27
6404-0404	7/16 - 20	1/4 - 18
6404-0406	7/16 - 20	3/8 - 18
6404-0502	1/2 - 20	1/8 - 27
6404-0604	9/16 - 18	1/4 - 18
6404-0606	9/16 - 18	3/8 - 18
6404-0608	9/16 - 18	1/2 - 14
6404-0806	3/4 - 16	3/8 - 18
6404-0808	3/4 - 16	1/2 - 14
6404-1008	7/8 - 14	1/2 - 14
6404-1212	1 1/16 - 12	3/4 - 14
6404-1616	1 5/16 - 12	1 - 11 1/2

BECAUSE WE CONTINUALLY EXAMINE WAYS TO IMPROVE OUR PRODUCTS, WE RESERVE THE RIGHT TO ALTER SPECIFICATIONS WITHOUT NOTICE.

# JIC and Pipe

## 6405 MORB - FP

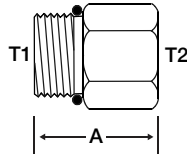

Part Number	T1	T2
	MORB	FNPT
6405-0402	7/16 - 20	1/8 - 27
6405-0404	7/16 - 20	1/4 - 18
6405-0406	7/16 - 20	3/8 - 18
6405-0502	1/2 - 20	1/8 - 27
6405-0504	1/2 - 20	1/4 - 18
6405-0602	9/16 - 18	1/8 - 27
6405-0604	9/16 - 18	1/4 - 18
6405-0606	9/16 - 18	3/8 - 18
6405-0608	9/16 - 18	1/2 - 14
6405-0802	3/4 - 16	1/8 - 27
6405-0804	3/4 - 16	1/4 - 18
6405-0806	3/4 - 16	3/8 - 18
6405-0808	3/4 - 16	1/2 - 14
6405-0812	3/4 - 16	3/4 - 14
6405-1004	7/8 - 14	1/4 - 18
6405-1006	7/8 - 14	3/8 - 18
6405-1008	7/8 - 14	1/2 - 14
6405-1012	7/8 - 14	3/4 - 14
6405-1204	1 1/16 - 12	1/4 - 18
6405-1206	1 1/16 - 12	3/8 - 18
6405-1208	1 1/16 - 12	1/2 - 14
6405-1212	1 1/16 - 12	3/4 - 14
6405-1216	1 1/16 - 12	1 - 11 1/2
6405-1412	1 3/16 - 12	3/4 - 14
6405-1606	1 5/16 - 12	3/8 - 18
6405-1608	1 5/16 - 12	1/2 - 14
6405-1612	1 5/16 - 12	3/4 - 14
6405-1616	1 5/16 - 12	1 - 11 1/2
6405-1620	1 5/16 - 12	1 1/4 - 11 1/2
6405-2012	1 5/8 - 12	3/4 - 14
6405-2016	1 5/8 - 12	1 - 11 1/2
6405-2020	1 5/8 - 12	1 1/4 - 11 1/2
6405-2024	1 5/8 - 12	1 1/2 - 11 1/2
6405-2412	1 7/8 - 12	3/4 - 14
6405-2416	1 7/8 - 12	1 - 11 1/2
6405-2420	1 7/8 - 12	1 1/4 - 11 1/2
6405-2424	1 7/8 - 12	1 1/2 - 11 1/2
6405-3232	2 1/2 - 12	2 - 11 1/2

## 6408 ORB Plug

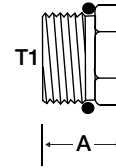

Part Number	T1
	MORB
6408-02	5/16 - 24
6408-03	3/8 - 24
6408-04	7/16 - 20
6408-05	1/2 - 20
6408-06	9/16 - 18
6408-08	3/4 - 16
6408-10	7/8 - 14
6408-12	1 1/16 - 12
6408-14	1 3/16 - 12
6408-16	1 5/16 - 12
6408-20	1 5/8 - 12
6408-24	1 7/8 - 12
6408-32	2 1/2 - 12

## 6408H ORB Hollow Hex Plug

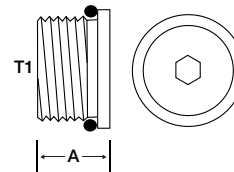

Part Number	T1
	MORB
6408H-02	5/16 - 24
6408H-03	3/8 - 24
6408H-04	7/16 - 20
6408H-05	1/2 - 20
6408H-06	9/16 - 18
6408H-08	3/4 - 16
6408H-10	7/8 - 14
6408H-12	1 1/16 - 12
6408H-14	1 3/16 - 12
6408H-16	1 5/16 - 12
6408H-20	1 5/8 - 12
6408H-24	1 7/8 - 12
6408H-32	2 1/2 - 12

BECAUSE WE CONTINUALLY EXAMINE WAYS TO IMPROVE OUR PRODUCTS, WE RESERVE THE RIGHT TO ALTER SPECIFICATIONS WITHOUT NOTICE.

## 6410 MORB - FORB

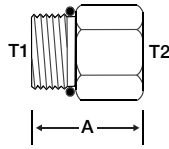

Part Number	T1	T2
	MORB	FORB
6410-0204	5/16 - 24	7/16 - 20
6410-0402	7/16 - 20	5/16 - 24
6410-0404	7/16 - 20	7/16 - 20
6410-0406	7/16 - 20	9/16 - 18
6410-0408	7/16 - 20	3/4 - 16
6410-0504	1/2 - 20	7/16 - 20
6410-0506	1/2 - 20	9/16 - 18
6410-0604	9/16 - 18	7/16 - 20
6410-0606	9/16 - 18	9/16 - 18
6410-0608	9/16 - 18	3/4 - 16
6410-0804	3/4 - 16	7/16 - 20
6410-0806	3/4 - 16	9/16 - 18
6410-0808	3/4 - 16	3/4 - 16
6410-0810	3/4 - 16	7/8 - 14
6410-0812	3/4 - 16	1 1/16 - 12
6410-1004	7/8 - 14	7/16 - 20
6410-1006	7/8 - 14	9/16 - 18
6410-1008	7/8 - 14	3/4 - 16
6410-1012	7/8 - 14	1 1/16 - 12
6410-1206	1 1/16 - 12	9/16 - 18
6410-1208	1 1/16 - 12	3/4 - 16
6410-1210	1 1/16 - 12	7/8 - 14
6410-1212	1 1/16 - 12	1 1/16 - 12
6410-1216	1 1/16 - 12	1 5/16 - 12
6410-1412	1 3/16 - 12	1 1/16 - 12
6410-1608	1 5/16 - 12	3/4 - 16
6410-1610	1 5/16 - 12	7/8 - 14
6410-1612	1 5/16 - 12	1 1/16 - 12
6410-1614	1 5/16 - 12	1 3/16 - 12
6410-1616	1 5/16 - 12	1 5/16 - 12
6410-1620	1 5/16 - 12	1 5/8 - 12
6410-2006	1 5/16 - 12	9/16 - 18
6410-2008	1 5/8 - 12	3/4 - 16
6410-2010	1 5/8 - 12	7/8 - 14
6410-2012	1 5/8 - 12	1 1/16 - 12
6410-2016	1 5/8 - 12	1 5/16 - 12
6410-2024	1 5/8 - 12	1 7/8 - 12
6410-2412	1 7/8 - 12	1 1/16 - 12
6410-2416	1 7/8 - 12	1 5/16 - 12
6410-2420	1 7/8 - 12	1 5/8 - 12
6410-3220	2 1/2 - 12	1 5/8 - 12
6410-3224	2 1/2 - 12	1 7/8 - 12

## 6500 MJ - FJX 90°

SAE# 070221

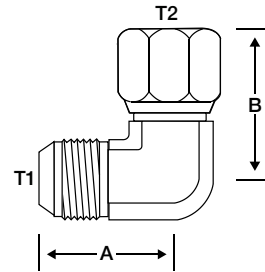

Part Number	T1	T2
	MJIC	FJIC
6500-0202	5/16 - 24	5/16 - 24
6500-0303	3/8 - 24	3/8 - 24
6500-0404	7/16 - 20	7/16 - 20
6500-0406	7/16 - 20	9/16 - 18
6500-0505	1/2 - 20	1/2 - 20
6500-0604	9/16 - 18	7/16 - 20
6500-0606	9/16 - 18	9/16 - 18
6500-0608	9/16 - 18	3/4 - 16
6500-0806	3/4 - 16	9/16 - 18
6500-0808	3/4 - 16	3/4 - 16
6500-0810	3/4 - 16	7/8 - 14
6500-0812	3/4 - 16	1 1/16 - 12
6500-1008	7/8 - 14	3/4 - 16
6500-1010	7/8 - 14	7/8 - 14
6500-1012	7/8 - 14	1 1/16 - 12
6500-1208	1 1/16 - 12	3/4 - 16
6500-1210	1 1/16 - 12	7/8 - 14
6500-1212	1 1/16 - 12	1 1/16 - 12
6500-1216	1 1/16 - 12	1 5/16 - 12
6500-1414	1 3/16 - 12	1 3/16 - 12
6500-1612	1 5/16 - 12	1 1/16 - 12
6500-1616	1 5/16 - 12	1 5/16 - 12
6500-2020	1 5/8 - 12	1 5/8 - 12
6500-2424	1 7/8 - 12	1 7/8 - 12
6500-3232	2 1/2 - 12	2 1/2 - 12

BECAUSE WE CONTINUALLY EXAMINE WAYS TO IMPROVE OUR PRODUCTS, WE RESERVE THE RIGHT TO ALTER SPECIFICATIONS WITHOUT NOTICE.

# JIC and Pipe

## 6501 MP - FJX 90°

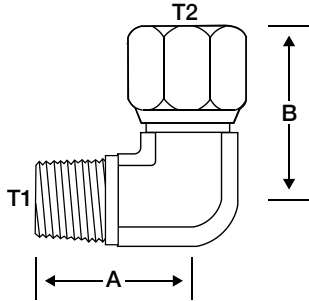

Part Number	T1	T2
	MNPT	FJIC
6501-0204	1/8 - 27	7/16 - 20
6501-0404	1/4 - 18	7/16 - 20
6501-0406	1/4 - 18	9/16 - 18
6501-0604	3/8 - 18	7/16 - 20
6501-0606	3/8 - 18	9/16 - 18
6501-0608	3/8 - 18	3/4 - 16
6501-0806	1/2 - 14	9/16 - 18
6501-0808	1/2 - 14	3/4 - 16
6501-0810	1/2 - 14	7/8 - 14
6501-1212	3/4 - 14	1 1/16 - 12
6501-1214	3/4 - 14	1 3/16 - 12
6501-1616	1 - 11 1/2	1 5/16 - 12
6501-2020	1 1/4 - 11 1/2	1 5/8 - 12
6501-2424	1 1/2 - 11 1/2	1 7/8 - 12
6501-3232	2 - 11 1/2	2 1/2 - 12

## 6502 MJ - FJX 45°

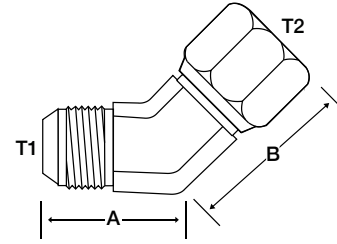

Part Number	T1	T2
	MJIC	FJIC
6502-0202	5/16 - 24	5/16 - 24
6502-0404	7/16 - 20	7/16 - 20
6502-0505	1/2 - 20	1/2 - 20
6502-0606	9/16 - 18	9/16 - 18
6502-0808	3/4 - 16	3/4 - 16
6502-1010	7/8 - 14	7/8 - 14
6502-1212	1 1/16 - 12	1 1/16 - 12
6502-1414	1 3/16 - 12	1 3/16 - 12
6502-1616	1 5/16 - 12	1 5/16 - 12
6502-2020	1 5/8 - 12	1 5/8 - 12
6502-2424	1 7/8 - 12	1 7/8 - 12
6502-3232	2 1/2 - 12	2 1/2 - 12

## 6504 MJ - FJX Straight

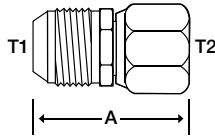

Part Number	T1	T2
	MJIC	FJIC
6504-0404	7/16 - 20	7/16 - 20
6504-0606	9/16 - 18	9/16 - 18
6504-0808	3/4 - 16	3/4 - 16
6504-1010	7/8 - 14	7/8 - 14
6504-1212	1 1/16 - 12	1 1/16 - 12
6504-1616	1 5/16 - 12	1 5/16 - 12
6504-2020	1 5/8 - 12	1 5/8 - 12

## 6505 MP - FJX Straight

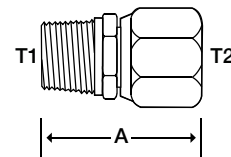

Part Number	T1	T2
	MNPT	FJIC
6505-0204	1/8 - 27	7/16 - 20
6505-0404	1/4 - 18	7/16 - 20
6505-0406	1/4 - 18	9/16 - 18
6505-0606	3/8 - 18	9/16 - 18
6505-0608	3/8 - 18	3/4 - 16
6505-0808	1/2 - 14	3/4 - 16
6505-0810	1/2 - 14	7/8 - 14
6505-0812	1/2 - 14	1 1/16 - 12
6505-1212	3/4 - 14	1 1/16 - 12
6505-1616	1 - 11 1/2	1 5/16 - 12
6505-2020	1 1/4 - 11 1/2	1 5/8 - 12
6505-2424	1 1/2 - 11 1/2	1 7/8 - 12

BECAUSE WE CONTINUALLY EXAMINE WAYS TO IMPROVE OUR PRODUCTS, WE RESERVE THE RIGHT TO ALTER SPECIFICATIONS WITHOUT NOTICE.



## 6506 FP - FJX Straight

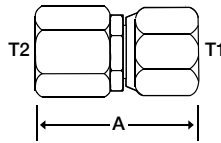

Part Number	T1	T2
	FNPT	FJIC
6506-0404	1/4 - 18	7/16 - 20
6506-0406	1/4 - 18	9/16 - 18
6506-0606	3/8 - 18	9/16 - 18
6506-0608	3/8 - 18	3/4 - 16
6506-0806	1/2 - 14	9/16 - 18
6506-0808	1/2 - 14	3/4 - 16
6506-0810	1/2 - 14	7/8 - 14
6506-1210	3/4 - 14	7/8 - 14
6506-1212	3/4 - 14	1 1/16 - 12
6506-1616	1 - 11 1/2	1 5/16 - 12
6506-2020	1 1/4 - 11 1/2	1 5/8 - 12

## 6565 FJX - FJX Straight

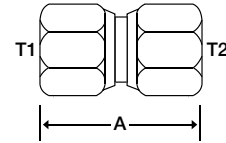

Part Number	T1	T2
	FJIC	FJIC
6565-0404	7/16 - 20	7/16 - 20
6565-0505	1/2 - 20	1/2 - 20
6565-0604	9/16 - 18	7/16 - 20
6565-0606	9/16 - 18	9/16 - 18
6565-0806	3/4 - 16	9/16 - 18
6565-0808	3/4 - 16	3/4 - 16
6565-1008	7/8 - 14	3/4 - 16
6565-1010	7/8 - 14	7/8 - 14
6565-1212	1 1/16 - 12	1 1/16 - 12
6565-1612	1 5/16 - 12	1 1/16 - 12
6565-1616	1 5/16 - 12	1 5/16 - 12
6565-2020	1 5/8 - 12	1 5/8 - 12
6565-2424	1 7/8 - 12	1 7/8 - 12

## 6600 MJ - MJ - FJ Tee

SAE# 070433

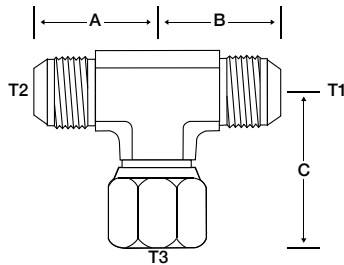

Part Number	T1 / T2	T3
	MJIC	FJIC
6600-030303	3/8 - 24	3/8 - 24
6600-040404	7/16 - 24	7/16 - 24
6600-050505	1/2 - 20	1/2 - 20
6600-060606	9/16 - 18	9/16 - 18
6600-060608	9/16 - 18	9/16 - 18
6600-080808	3/4 - 16	3/4 - 16
6600-101010	7/8 - 14	7/8 - 14
6600-121212	1 1/16 - 12	1 1/16 - 12
6600-141414	1 3/16 - 12	1 3/16 - 12
6600-161616	1 5/16 - 12	1 5/16 - 12
6600-202020	1 5/8 - 12	1 5/8 - 12
6600-242424	1 7/8 - 12	1 7/8 - 12
6600-323232	2 1/2 - 12	2 1/2 - 12

BECAUSE WE CONTINUALLY EXAMINE WAYS TO IMPROVE OUR PRODUCTS, WE RESERVE THE RIGHT TO ALTER SPECIFICATIONS WITHOUT NOTICE.

# JIC and Pipe

## 6602 MJ - FJX - MJ Tee

SAE# 070432

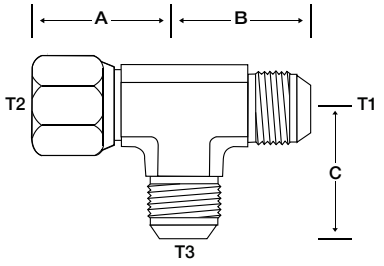

Part Number	T1 / T3	T2
	MJIC	FJIC
6602-030303	3/8 - 24	3/8 - 24
6602-040404	7/16 - 24	7/16 - 24
6602-050505	1/2 - 20	1/2 - 20
6602-060604	9/16 - 18	9/16 - 18
6602-060606	9/16 - 18	9/16 - 18
6602-080806	3/4 - 16	3/4 - 16
6602-080808	3/4 - 16	3/4 - 16
6602-080812	3/4 - 16	3/4 - 16
6602-101010	7/8 - 14	7/8 - 14
6602-101012	7/8 - 14	7/8 - 14
6602-121212	1 1/16 - 12	1 1/16 - 12
6602-141414	1 3/16 - 12	1 3/16 - 12
6602-161610	1 5/16 - 12	1 5/16 - 12
6602-161616	1 5/16 - 12	1 5/16 - 12
6602-202020	1 5/8 - 12	1 5/8 - 12
6602-242424	1 7/8 - 12	1 7/8 - 12
6602-323232	2 1/2 - 12	2 1/2 - 12

## 6603 FJX - FJX - MJ Tee

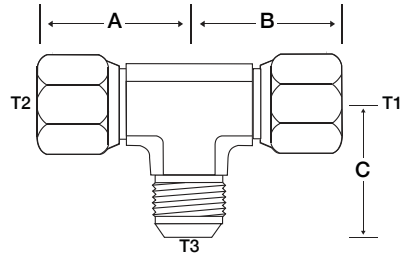

Part Number	T1/ T2	T3
	FJIC	MJIC
6603-080808	3/4 - 16	3/4 - 16
6603-101010	7/8 - 14	7/8 - 14
6603-121212	1 1/16 - 12	1 1/16 - 12
6603-161616	1 5/16 - 12	1 5/16 - 12

## 6701 MJ - FJX 90° Tube

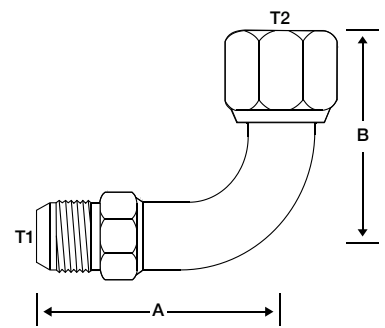

Part Number	T1	T2
	MJIC	FJIC
6701-0404	7/16 - 20	7/16 - 20
6701-0606	9/16 - 18	9/16 - 18
6701-0808	3/4 - 16	3/4 - 16
6701-1010	7/8 - 14	7/8 - 14
6701-1212	1 1/16 - 12	1 1/16 - 12
6701-1616	1 5/16 - 12	1 5/16 - 12
6701-2020	1 5/8 - 12	1 5/8 - 12

## 6606 FJX - FJX - FJX Tee

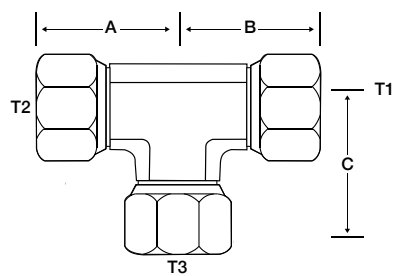

Part Number	T1 / T2 / T3
	FJIC
6606-040404	7/16 - 20
6606-060606	9/16 - 18
6606-080808	3/4 - 16
6606-121212	1 1/16 - 12
6606-161616	1 5/16 - 12

BECAUSE WE CONTINUALLY EXAMINE WAYS TO IMPROVE OUR PRODUCTS, WE RESERVE THE RIGHT TO ALTER SPECIFICATIONS WITHOUT NOTICE.

## 6701L MJ - FJX 90° Long Tube

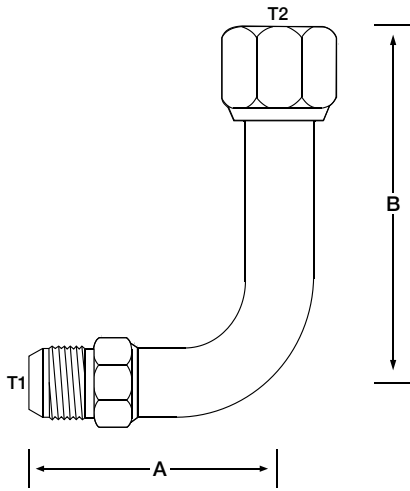

## 6702 MJ - FJX 45° Tube

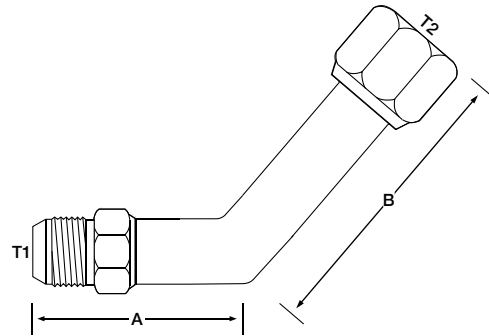

Part Number	T1	T2
	MJIC	FJIC
6701L-0404	7/16 - 20	7/16 - 20
6701L-0606	9/16 - 18	9/16 - 18
6701L-0808	3/4 - 16	3/4 - 16
6701L-1212	1 1/16 - 12	1 1/16 - 12
6701L-1616	1 5/16 - 12	1 5/16 - 12
6701L-2020	1 5/8 - 12	1 5/8 - 12

Part Number	T1	T2
	MJIC	FJIC
6702-0404	7/16 - 20	7/16 - 20
6702-0606	9/16 - 18	9/16 - 18
6702-0808	3/4 - 16	3/4 - 16
6702-1212	1 1/16 - 12	1 1/16 - 12
6702-1616	1 5/16 - 12	1 5/16 - 12
6702-2020	1 5/8 - 12	1 5/8 - 12

# JIC and Pipe

## 6801 MJ - MAORB 90° SAE# 070220

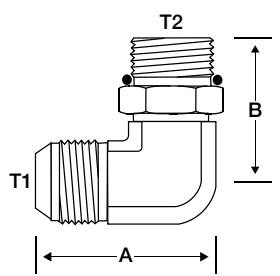

Part Number	T1	T2
	MJIC	MORB
6801-0202	5/16 - 24	5/16 - 24
6801-0303	3/8 - 24	3/8 - 24
6801-0402	7/16 - 20	5/16 - 24
6801-0403	7/16 - 20	3/8 - 24
6801-0404	7/16 - 20	7/16 - 20
6801-0405	7/16 - 20	1/2 - 20
6801-0406	7/16 - 20	9/16 - 18
6801-0408	7/16 - 20	3/4 - 16
6801-0504	1/2 - 20	7/16 - 20
6801-0505	1/2 - 20	1/2 - 20
6801-0506	1/2 - 20	9/16 - 18
6801-0508	1/2 - 20	3/4 - 16
6801-0604	9/16 - 18	7/16 - 24
6801-0605	9/16 - 18	1/2 - 20
6801-0606	9/16 - 18	9/16 - 18
6801-0608	9/16 - 18	3/4 - 16
6801-0610	9/16 - 18	7/8 - 14
6801-0612	9/16 - 18	1 1/16 - 12
6801-0804	3/4 - 16	7/16 - 20
6801-0806	3/4 - 16	9/16 - 18
6801-0808	3/4 - 16	3/4 - 16
6801-0810	3/4 - 16	7/8 - 14
6801-0812	3/4 - 16	1 1/16 - 12
6801-0816	3/4 - 16	1 5/16 - 12
6801-1006	7/8 - 14	9/16 - 18
6801-1008	7/8 - 14	3/4 - 16
6801-1010	7/8 - 14	7/8 - 14
6801-1012	7/8 - 14	1 1/16 - 12
6801-1016	7/8 - 14	1 5/16 - 12
6801-1206	1 1/16 - 12	9/16 - 18
6801-1208	1 1/16 - 12	3/4 - 16
6801-1210	1 1/16 - 12	7/8 - 14
6801-1212	1 1/16 - 12	1 1/16 - 12

Part Number	T1	T2
	MJIC	MORB
6801-1214	1 1/16 - 12	1 3/16 - 12
6801-1216	1 1/16 - 12	1 5/16 - 12
6801-1220	1 1/16 - 12	1 5/8 - 12
6801-1412	1 3/16 - 12	1 1/16 - 12
6801-1414	1 3/16 - 12	1 3/16 - 12
6801-1608	1 5/16 - 12	3/4 - 16
6801-1610	1 5/16 - 12	7/8 - 14
6801-1612	1 5/16 - 12	1 1/16 - 12
6801-1614	1 5/16 - 12	1 3/16 - 12
6801-1616	1 5/16 - 12	1 5/16 - 12
6801-1620	1 5/16 - 12	1 5/8 - 12
6801-1624	1 5/16 - 12	1 7/8 - 12
6801-2012	1 5/8 - 12	1 1/16 - 12
6801-2016	1 5/8 - 12	1 5/16 - 12
6801-2020	1 5/8 - 12	1 5/8 - 12
6801-2024	1 5/8 - 12	1 7/8 - 12
6801-2416	1 7/8 - 12	1 5/16 - 12
6801-2420	1 7/8 - 12	1 5/8 - 12
6801-2424	1 7/8 - 12	1 7/8 - 12
6801-3224	2 1/2 - 12	1 7/8 - 12
6801-3232	2 1/2 - 12	2 1/2 - 12

BECAUSE WE CONTINUALLY EXAMINE WAYS TO IMPROVE OUR PRODUCTS, WE RESERVE THE RIGHT TO ALTER SPECIFICATIONS WITHOUT NOTICE.

## 6801L MJ - MAORB 90° Long

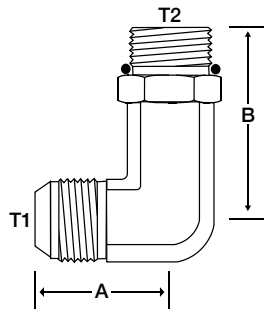

Part Number	T1	T2
	MJIC	MORB
6801L-0404	7/16 - 20	7/16 - 20
6801L-0406	7/16 - 20	9/16 - 18
6801L-0606	9/16 - 18	9/16 - 18
6801L-0608	9/16 - 18	3/4 - 16
6801L-0808	3/4 - 16	3/4 - 16
6801L-0810	3/4 - 16	7/8 - 14
6801L-1008	7/8 - 14	3/4 - 16
6801L-1010	7/8 - 14	7/8 - 14
6801L-1212	1 1/16 - 12	1 1/16 - 12
6801L-1616	1 5/16 - 12	1 5/16 - 12

## 6801LL MJ - MAORB 90° X-Long

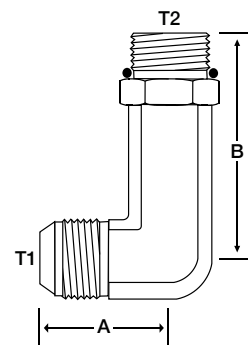

Part Number	T1	T2
	MJIC	MORB
6801LL-0404	7/16 - 20	7/16 - 20
6801LL-0606	9/16 - 18	9/16 - 18
6801LL-0608	9/16 - 18	3/4 - 16
6801LL-0806	3/4 - 16	9/16 - 18
6801LL-0808	3/4 - 16	3/4 - 16
6801LL-0810	3/4 - 16	7/8 - 14
6801LL-1008	7/8 - 14	3/4 - 16
6801LL-1010	7/8 - 14	7/8 - 14
6801LL-1212	1 1/16 - 12	1 1/16 - 12
6801LL-1216	1 1/16 - 12	1 5/16 - 12
6801LL-1612	1 5/16 - 12	1 1/16 - 12
6801LL-1616	1 5/16 - 12	1 5/16 - 12
6801LL-2020	1 5/8 - 12	1 5/8 - 12

## 6801LLL MJ - MAORB 90° XX-Long

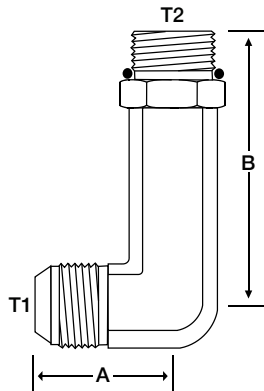

Part Number	T1	T2
	MJIC	MORB
6801LLL-0404	7/16 - 20	7/16 - 20
6801LLL-0606	9/16 - 18	9/16 - 18
6801LLL-0608	9/16 - 18	3/4 - 16
6801LLL-0808	3/4 - 16	3/4 - 16

BECAUSE WE CONTINUALLY EXAMINE WAYS TO IMPROVE OUR PRODUCTS, WE RESERVE THE RIGHT TO ALTER SPECIFICATIONS WITHOUT NOTICE.

# JIC and Pipe

## 6802 MJ - MAORB 45°

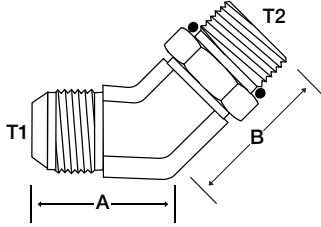

## 6803 MJ - MJ - MAORB Tee

SAE# 070429

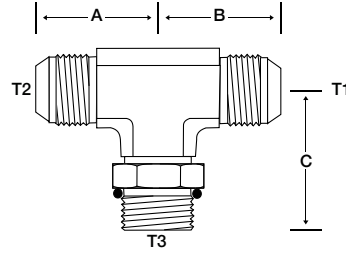

Part Number	T1	T2
	MJIC	MORB
6802-0202	5/16 - 24	5/16 - 24
6802-0404	7/16 - 20	7/16 - 20
6802-0405	7/16 - 20	1/2 - 20
6802-0406	7/16 - 20	9/16 - 18
6802-0408	7/16 - 20	3/4 - 16
6802-0504	1/2 - 20	7/16 - 20
6802-0505	1/2 - 20	1/2 - 20
6802-0506	1/2 - 20	9/16 - 18
6802-0604	9/16 - 18	7/16 - 20
6802-0605	9/16 - 18	1/2 - 20
6802-0606	9/16 - 18	9/16 - 18
6802-0608	9/16 - 18	3/4 - 16
6802-0610	9/16 - 18	7/8 - 14
6802-0804	3/4 - 16	7/16 - 20
6802-0806	3/4 - 16	9/16 - 18
6802-0808	3/4 - 16	3/4 - 16
6802-0810	3/4 - 16	7/8 - 14
6802-0812	3/4 - 16	1 1/16 - 12
6802-1008	7/8 - 14	3/4 - 16
6802-1010	7/8 - 14	7/8 - 14
6802-1012	7/8 - 14	1 1/16 - 12
6802-1208	1 1/16 - 12	3/4 - 16
6802-1210	1 1/16 - 12	7/8 - 14
6802-1212	1 1/16 - 12	1 1/16 - 12
6802-1216	1 1/16 - 12	1 5/16 - 12
6802-1414	1 3/16 - 12	1 3/16 - 12
6802-1612	1 5/16 - 12	1 1/16 - 12
6802-1616	1 5/16 - 12	1 5/16 - 12
6802-1620	1 5/16 - 12	1 5/8 - 12
6802-2016	1 5/8 - 12	1 5/16 - 12
6802-2020	1 5/8 - 12	1 5/8 - 12
6802-2424	1 7/8 - 12	1 7/8 - 12
6802-3232	2 1/2 - 12	2 1/2 - 12

Part Number	T1 / T2	T3
	MJIC	MORB
6803-040404	7/16 - 20	7/16 - 20
6803-040406	7/16 - 20	9/16 - 18
6803-050505	1/2 - 20	1/2 - 20
6803-060604	9/16 - 18	7/16 - 20
6803-060606	9/16 - 18	9/16 - 18
6803-060608	9/16 - 18	3/4 - 16
6803-080806	3/4 - 16	9/16 - 18
6803-080808	3/4 - 16	3/4 - 16
6803-080810	3/4 - 16	7/8 - 14
6803-101010	7/8 - 14	7/8 - 14
6803-101012	7/8 - 14	1 1/16 - 12
6803-121208	1 1/16 - 12	3/4 - 16
6803-121210	1 1/16 - 12	7/8 - 14
6803-121212	1 1/16 - 12	1 1/16 - 12
6803-121216	1 1/16 - 12	1 5/16 - 12
6803-161216	1 5/16 - 12	1 5/16 - 12
6803-161612	1 5/16 - 12	1 1/16 - 12
6803-161616	1 5/16 - 12	1 5/16 - 12
6803-202020	1 5/8 - 12	1 5/8 - 12
6803-242424	1 7/8 - 12	1 7/8 - 12
6803-323232	2 1/2 - 12	2 1/2 - 12

BECAUSE WE CONTINUALLY EXAMINE WAYS TO IMPROVE OUR PRODUCTS, WE RESERVE THE RIGHT TO ALTER SPECIFICATIONS WITHOUT NOTICE.

## 6804 MJ - MAORB - MJ Tee

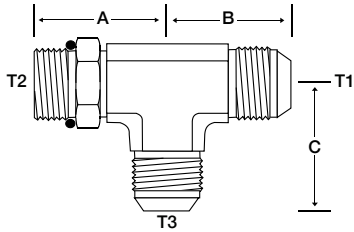

Part Number	T1 / T3	T2
	MJIC	MORB
6804-040404	7/16 - 20	7/16 - 20
6804-040604	7/16 - 20	7/16 - 20
6804-050505	1/2 - 20	1/2 - 20
6804-060406	9/16 - 18	7/16 - 20
6804-060606	9/16 - 18	9/16 - 18
6804-060806	9/16 - 18	3/4 - 16
6804-080608	3/4 - 16	9/16 - 18
6804-080804	3/4 - 16	3/4 - 16
6804-080808	3/4 - 16	3/4 - 16
6804-081008	3/4 - 16	7/8 - 14
6804-101010	7/8 - 14	7/8 - 14
6804-101210	7/8 - 14	1 1/16 - 12
6804-121012	1 1/16 - 12	7/8 - 14
6804-121208	1 1/16 - 12	1 1/16 - 12
6804-121212	1 1/16 - 12	1 1/16 - 12
6804-121216	1 1/16 - 12	1 1/16 - 12
6804-121612	1 1/16 - 12	1 5/16 - 12
6804-161216	1 5/16 - 12	1 1/16 - 12
6804-161612	1 5/16 - 12	1 5/16 - 12
6804-161616	1 5/16 - 12	1 5/16 - 12
6804-202020	1 5/8 - 12	1 5/8 - 12
6804-242424	1 7/8 - 12	1 7/8 - 12
6804-323232	2 1/2 - 12	2 1/2 - 12

BECAUSE WE CONTINUALLY EXAMINE WAYS TO IMPROVE OUR PRODUCTS, WE RESERVE THE RIGHT TO ALTER SPECIFICATIONS WITHOUT NOTICE.

# JIC and Pipe

## 6805 MAORB - FP 90°

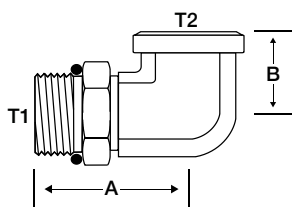

Part Number	T1	T2
	MORB	FNPT
6805-0402	7/16 - 20	1/8 - 27
6805-0404	7/16 - 20	1/4 - 18
6805-0406	7/16 - 20	3/8 - 18
6805-0502	1/2 - 20	1/8 - 27
6805-0604	9/16 - 18	1/4 - 18
6805-0606	9/16 - 18	3/8 - 18
6805-0806	3/4 - 16	3/8 - 18
6805-0808	3/4 - 16	1/2 - 14
6805-1006	7/8 - 14	3/8 - 18
6805-1008	7/8 - 14	1/2 - 14
6805-1208	1 1/16 - 12	1/2 - 14
6805-1212	1 1/16 - 12	3/4 - 14
6805-1412	1 3/16 - 12	3/4 - 14
6805-1612	1 5/16 - 12	3/4 - 14
6805-1616	1 5/16 - 12	1 - 11 1/2
6805-2020	1 5/8 - 12	1 1/4 - 11 1/2
6805-2424	1 7/8 - 12	1 1/2 - 11 1/2
6805-3232	2 1/2 - 12	2 - 11 1/2

## 6806 MAORB - MP 90°

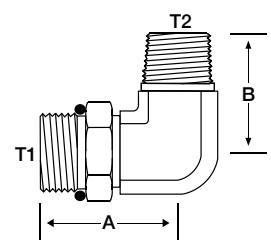

Part Number	T1	T2
	MORB	MNPT
6806-0402	7/16 - 20	1/8 - 27
6806-0404	7/16 - 20	1/4 - 18
6806-0502	1/2 - 20	1/8 - 27
6806-0604	9/16 - 18	1/4 - 18
6806-0606	9/16 - 18	3/8 - 18
6806-0806	3/4 - 16	3/8 - 18
6806-0808	3/4 - 16	1/2 - 14
6806-1008	7/8 - 14	1/2 - 1
6806-1212	1 1/16 - 12	3/4 - 14
6806-1412	1 3/16 - 12	3/4 - 14
6806-1612	1 5/16 - 12	3/4 - 14
6806-1616	1 5/16 - 12	1 - 11 1/2
6806-2020	1 5/8 - 12	1 1/4 - 11 1/2
6806-2424	1 7/8 - 12	1 1/2 - 11 1/2
6806-3232	2 1/2 - 12	2 - 11 1/2

## 6805L MAORB - FP 90° Long

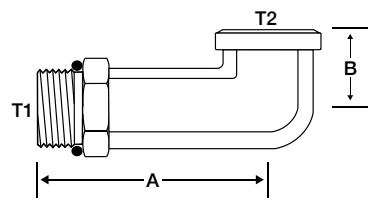

Part Number	T1	T2
	MORB	FNPT
6805L-0808	3/4 - 16	1/2 - 14
6805L-1008	7/8 - 14	1/2 - 14
6805L-1212	1 1/16 - 12	3/4 - 14

## 6807 MAORB - MAORB 90°

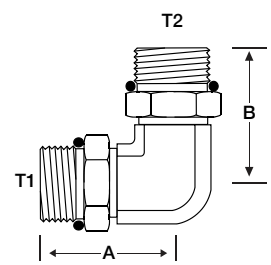

Part Number	T1	T2
	MORB	MORB
6807-0404	7/16 - 20	7/16 - 20
6807-0606	9/16 - 18	9/16 - 18
6807-0806	3/4 - 16	9/16 - 18
6807-0808	3/4 - 16	3/4 - 16
6807-1008	7/8 - 14	3/4 - 16
6807-1010	7/8 - 14	7/8 - 14
6807-1212	1 1/16 - 12	1 1/16 - 12
6807-1616	1 5/16 - 12	1 5/16 - 12
6807-2020	1 5/8 - 12	1 5/8 - 12
6807-2424	1 7/8 - 12	1 7/8 - 12

BECAUSE WE CONTINUALLY EXAMINE WAYS TO IMPROVE OUR PRODUCTS, WE RESERVE THE RIGHT TO ALTER SPECIFICATIONS WITHOUT NOTICE.



## 6809 MAORB - FJX 90°

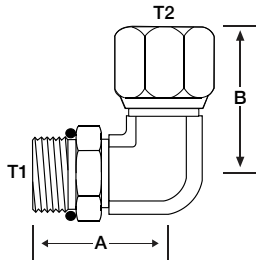

## 6815 MAORB - FORB 90°

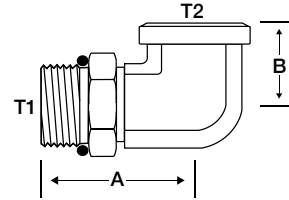

Part Number	T1	T2
	MORB	FJIC
6809-0404	7/16 - 20	7/16 - 20
6809-0604	9/16 - 18	7/16 - 20
6809-0606	9/16 - 18	9/16 - 18
6809-0806	3/4 - 16	9/16 - 18
6809-0808	3/4 - 16	3/4 - 16
6809-1010	7/8 - 14	7/8 - 14
6809-1210	1 1/16 - 12	7/8 - 14
6809-1212	1 1/16 - 12	1 1/16 - 12
6809-1616	1 5/16 - 12	1 5/16 - 12
6809-2020	1 5/8 - 12	1 5/8 - 12
6809-0404	7/16 - 20	7/16 - 20
6809-0604	9/16 - 18	7/16 - 20
6809-0606	9/16 - 18	9/16 - 18
6809-0806	3/4 - 16	9/16 - 18
6809-0808	3/4 - 16	3/4 - 16
6809-1010	7/8 - 14	7/8 - 14
6809-1210	1 1/16 - 12	7/8 - 14
6809-1212	1 1/16 - 12	1 1/16 - 12
6809-1616	1 5/16 - 12	1 5/16 - 12
6809-2020	1 5/8 - 12	1 5/8 - 12

Part Number	T1	T2
	MORB	FORB
6815-0404	7/16 - 20	7/16 - 20
6815-0606	9/16 - 18	9/16 - 18
6815-0808	3/4 - 16	3/4 - 16
6815-1010	7/8 - 14	7/8 - 14
6815-1212	1 1/16 - 12	1 1/16 - 12
6815-1616	1 5/16 - 12	1 5/16 - 12

## 6835 MAORB - FORB - FORB Tee

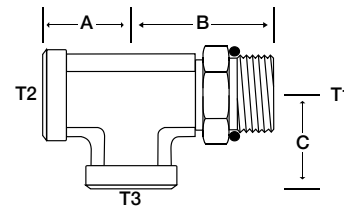

Part Number	T1	T2 / T3
	MORB	FORB
6835-040404	7/16 - 20	7/16 - 20
6835-060606	9/16 - 18	9/16 - 18
6835-080808	3/4 - 16	3/4 - 16
6835-121212	1 1/16 - 12	1 1/16 - 12
6835-161616	1 5/16 - 12	1 5/16 - 12

# JIC and Pipe

## 6900 MAORB - FPX

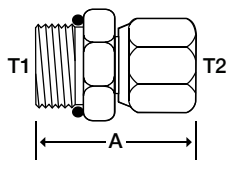

Part Number	T1	T2
	MORB	FNPSM
6900-0404	7/16 - 20	1/4 - 18
6900-0406	7/16 - 20	3/8 - 18
6900-0504	1/2 - 20	1/4 - 18
6900-0604	9/16 - 18	1/4 - 18
6900-0606	9/16 - 18	3/8 - 18
6900-0608	9/16 - 18	1/2 - 14
6900-0804	3/4 - 16	1/4 - 18
6900-0806	3/4 - 16	3/8 - 18
6900-0808	3/4 - 16	1/2 - 14
6900-0812	3/4 - 16	3/4 - 14
6900-1006	7/8 - 14	3/8 - 18
6900-1008	7/8 - 14	1/2 - 14
6900-1012	7/8 - 14	3/4 - 14
6900-1206	1 1/16 - 12	3/8 - 18
6900-1208	1 1/16 - 12	1/2 - 14
6900-1212	1 1/16 - 12	3/4 - 14
6900-1216	1 1/16 - 12	1 - 11 1/2
6900-1412	1 3/16 - 12	3/4 - 14
6900-1612	1 5/16 - 12	3/4 - 14
6900-1616	1 5/16 - 12	1 - 11 1/2
6900-1620	1 5/16 - 12	1 1/4 - 11 1/2
6900-2016	1 5/8 - 12	1 - 11 1/2
6900-2020	1 5/8 - 12	1 1/4 - 11 1/2
6900-2424	1 7/8 - 12	1 1/2 - 11 1/2
6900-3232	2 1/2 - 12	2 - 11 1/2

## 6901 MAORB - FPX 90°

SAE# 140257

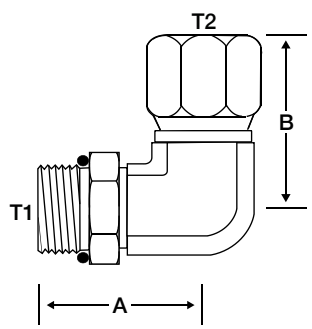

Part Number	T1	T2
	MORB	FNPSM
6901-0404	7/16 - 20	1/4 - 18
6901-0406	7/16 - 20	3/8 - 18
6901-0604	9/16 - 18	1/4 - 18
6901-0606	9/16 - 18	3/8 - 18
6901-0608	9/16 - 18	1/2 - 14
6901-0804	3/4 - 16	1/4 - 18
6901-0806	3/4 - 16	3/8 - 18
6901-0808	3/4 - 16	1/2 - 14
6901-0812	3/4 - 16	3/4 - 14
6901-1006	7/8 - 14	3/8 - 18
6901-1008	7/8 - 14	1/2 - 14
6901-1012	7/8 - 14	3/4 - 14
6901-1206	1 1/16 - 12	3/8 - 18
6901-1208	1 1/16 - 12	1/2 - 14
6901-1212	1 1/16 - 12	3/4 - 14
6901-1216	1 1/16 - 12	1 - 11 1/2
6901-1412	1 3/16 - 12	3/4 - 14
6901-1612	1 5/16 - 12	3/4 - 14
6901-1616	1 5/16 - 12	1 - 11 1/2
6901-1620	1 5/16 - 12	1 1/4 - 11 1/2
6901-2012	1 5/8 - 12	3/4 - 14
6901-2016	1 5/8 - 12	1 - 11 1/2
6901-2020	1 5/8 - 12	1 1/4 - 11 1/2
6901-2420	1 7/8 - 12	1 1/4 - 11 1/2
6901-2424	1 7/8 - 12	1 1/2 - 11 1/2
6901-3232	2 1/2 - 12	2 - 11 1/2

BECAUSE WE CONTINUALLY EXAMINE WAYS TO IMPROVE OUR PRODUCTS, WE RESERVE THE RIGHT TO ALTER SPECIFICATIONS WITHOUT NOTICE.

## 6902 MAORB - FPX 45°

SAE# 140357

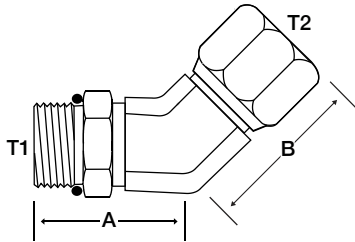

Part Number	T1	T2
	MORB	FNPSM
6902-0404	7/16 - 20	1/4 - 18
6902-0604	9/16 - 18	1/4 - 18
6902-0606	9/16 - 18	3/8 - 18
6902-0608	9/16 - 18	1/2 - 14
6902-0806	3/4 - 16	3/8 - 18
6902-0808	3/4 - 16	1/2 - 14
6902-0812	3/4 - 16	3/4 - 14
6902-1006	7/8 - 14	3/8 - 18
6902-1008	7/8 - 14	1/2 - 14
6902-1012	7/8 - 14	3/4 - 14
6902-1206	1 1/16 - 12	3/8 - 18
6902-1208	1 1/16 - 12	1/2 - 14
6902-1212	1 1/16 - 12	3/4 - 14
6902-1616	1 5/16 - 12	1 - 11 1/2
6902-2020	1 5/8 - 12	1 1/4 - 11 1/2
6902-2424	1 7/8 - 12	1 1/2 - 11 1/2